

TRANSFORMATION OF KEY SPACES

B3

B1 Illustrative Design
Principles



B2 Illustrative Masterplan



B3 Transformation of
Key Spaces

Key places
Streets and Green Links

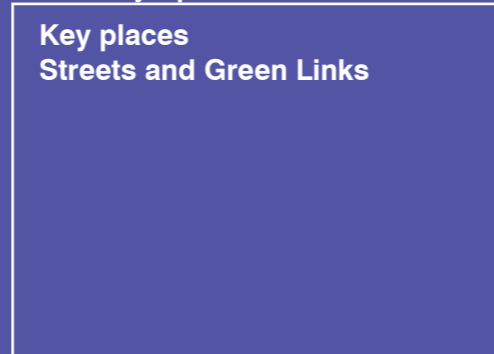

8. TRANSFORMATION OF KEY SPACES

8.1. Key places

West Forum spaces

8.1.1 The West Forum is one of two primary urban public spaces and forms a focus for activity for the west of the site. This space is a key element retained and brought through from the previous masterplan.

Role in the Masterplan

- The space will be transformed to become the focus of the Commercial Research cluster to the west of the West Cambridge site;
- An arrival space for the west side of West Cambridge - forms the termination of High Cross and so links directly to the North West Cambridge Development, and specifically its Local Centre.

Surrounding uses

- The focus for commercial research, community and social spaces - located directly on or adjacent to the squares are the sports centre, active uses such as cafés, entrances to commercial buildings and a proposed Innovation Centre;
- Existing academic buildings form the eastern frontage to the space;
- It forms the key gateway to the commercial research use cluster located west and north of the Forum;
- Consisting almost entirely of new build floorspace, the commercial research buildings will form a new western frontage of the West Forum spaces.

Movement

- The West Forum consists of a series of linked pedestrian only spaces: Upper Square, West Forum Terraces and West Lake;
- Bus routes and stops are located adjacent to the Upper Square, and there is potential for the future Arc route bus stop to be located close-by;
- Car drop-off for visitors is accommodated in the Upper Square;
- A key existing strategic east-west cycle route runs through the space along the Southern Ecological Corridor - between the West Lake and West Terraces.



Key plan

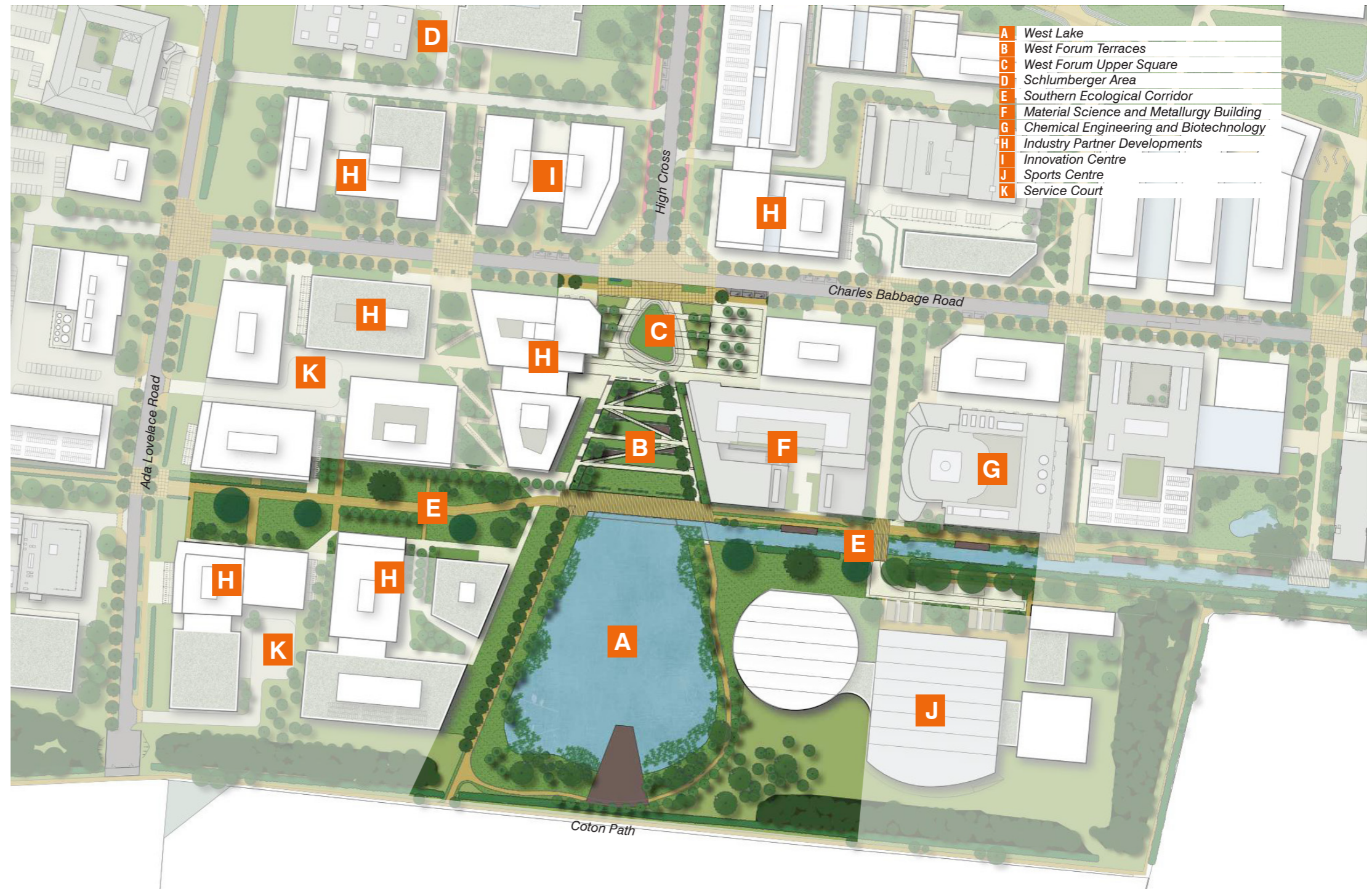

- A West Lake
- B West Forum Terraces
- C West Forum Upper Square
- D Schlumberger Area
- E Southern Ecological Corridor
- F Material Science and Metallurgy Building
- G Chemical Engineering and Biotechnology
- H Industry Partner Developments
- I Innovation Centre
- J Sports Centre
- K Service Court

260. The West Forum spaces

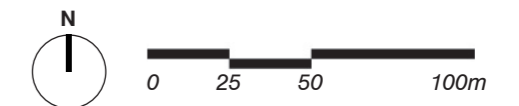



Key plan for section

Scale of spaces

8.1.2 The scale of the West Forum spaces are influenced by the existing spaces and buildings, including the West Lake and the terraced landscape. The terraced landscape will maintain its dimensions (about 50x50m) and the lake area will be slightly enlarged, to about 170x155m.

8.1.3 Proposed development to the west will provide new frontage and enclosure as well as bring a new activity to the spaces. The Upper Square will form an arrival point and new development will restrict the space to approximately 40x90m in size. Care is taken to maintain views to the southern countryside while providing shelter from wind and noise.

Description of West Forum spaces

- The West Forum is a sequence of spaces, negotiating the topography of this part of the site, with the three spaces located on different levels and stepping down towards the Southern Ecological Corridor and the lake;

- New development introduces enclosure and active frontages to the western side of the space;
- Distant views over the southern countryside are provided from the Upper Square and the West Forum Terraces;
- The existing woodland is retained and reinforced to create a sense of enclosure to West Forum and provide a backdrop for West Lake.

The **West Forum Terraces** is a landscaped space that provides views over the lake and a stepped and ramp connection to the two main public spaces - the Upper Square and West Lake.

The **Upper Square** develop a foreground for the lakeside in the form of informal meeting areas and a vehicular drop off square.

The third space, **West Lake**, is a revitalised green space around the existing lake - pedestrian access is allowed to the edges of the lake and active uses front onto the lake on the new western frontage creating a space for connecting with nature.



262. Queen Elizabeth London Olympic Park

Steps and terraces work as informal gathering spaces in London Olympic Park to negotiate the level difference as the land slopes towards the canal



263. Queen Elizabeth London Olympic Park



261. The West Forum - section



Key plan for views

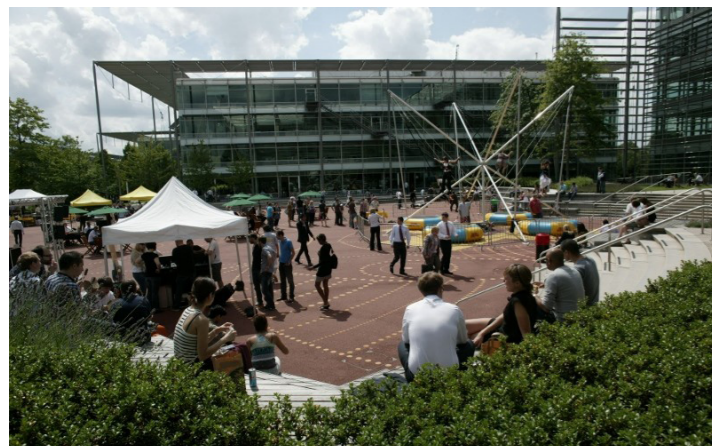

265. Precedents for the West Forum spaces

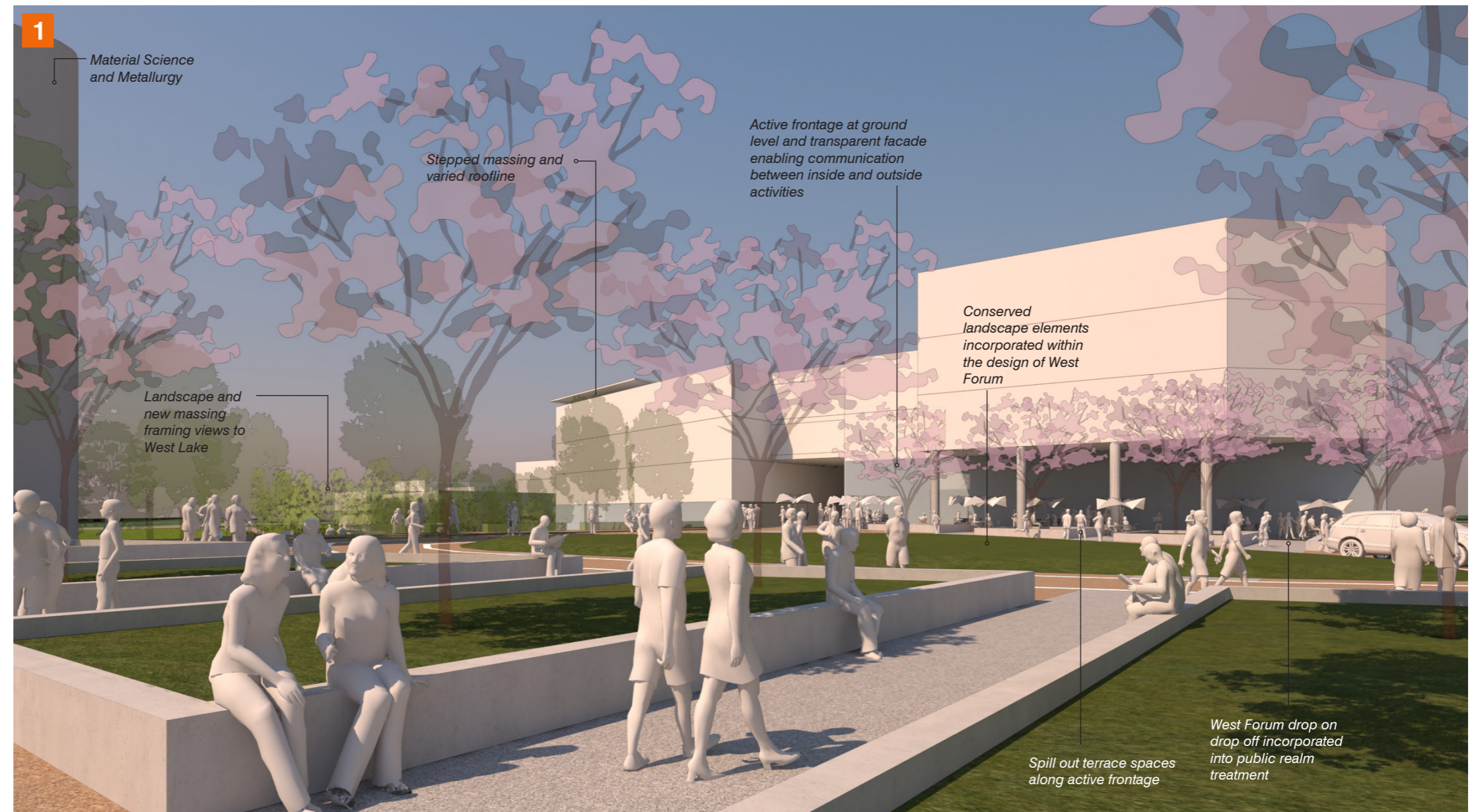

264. The West Forum spaces: West Forum Upper Square as viewed from Charles Babbage Road

Active uses and social spaces on the ground floors of commercial buildings facing the West Forum, ensure necessary active frontage and vibrancy to the open space. The Upper Square forms an important arrival point experience.



Key plan for views



267. Precedents for West Forum spaces

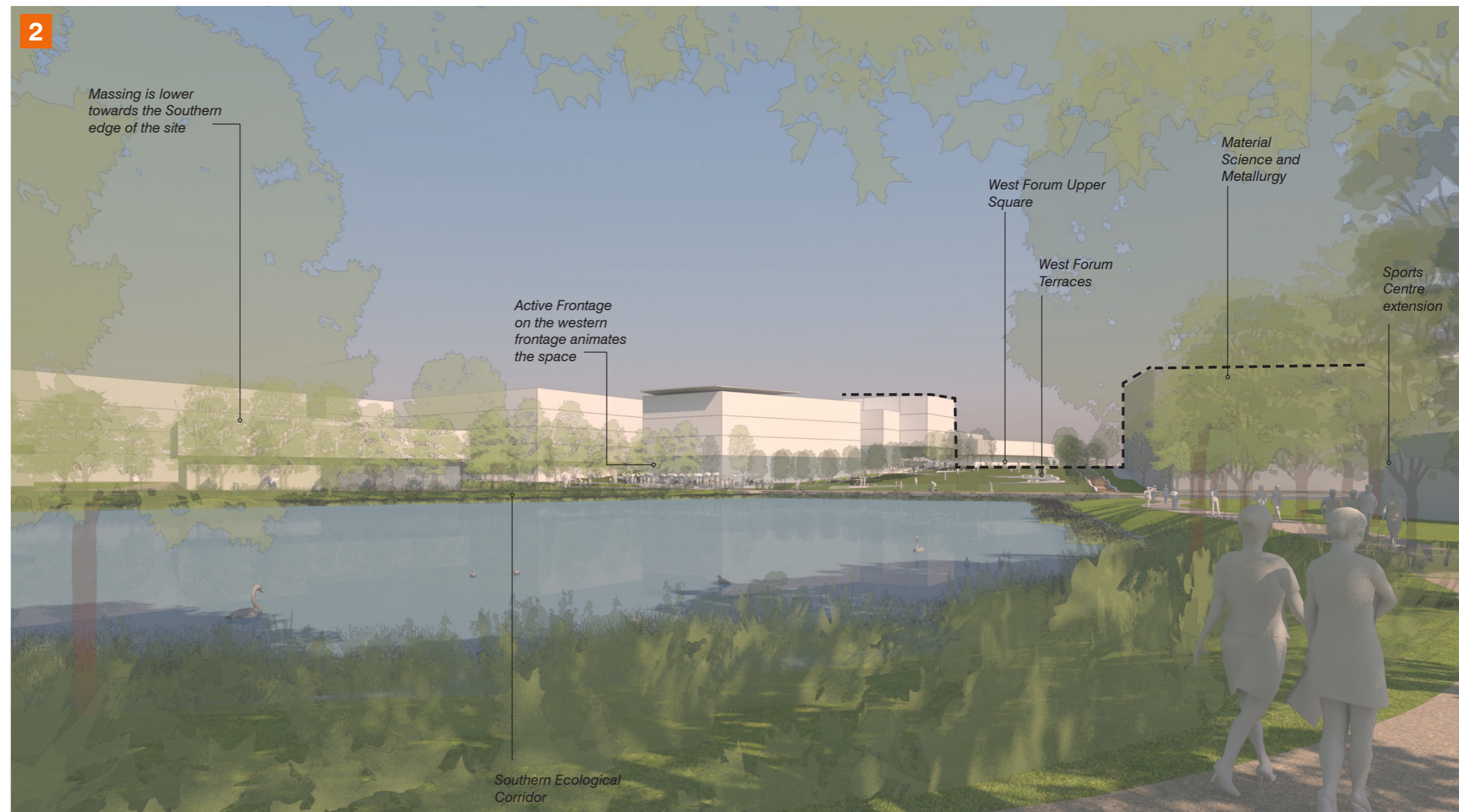

266. The West Forum spaces: view from south of the West Lake to other Forum spaces

The southern-most part of West Forum will be developed as a dense woodland area accessible via a jogging / walking path that provides a vantage point to enjoy the natural setting and view the active area of the West Terraces and new development frontage from across the lake.

East Forum spaces

8.1.4 The East Forum is the second of two primary urban public spaces and forms a focus for activity for the east of the site. The East Forum forms part of the primary open space network and is one of key elements retained from previous consented masterplan.

Role in the Masterplan

- The space is transformed to become the focus of the Academic cluster to the east of the West Cambridge site.
- It is a new pedestrian route from the south-eastern corner of the site and connects the East Forum spaces to the Coton Footpath and Cambridge City Centre.
- As an arrival space from JJ Thomson Avenue it provides a key north-south link between academic clusters of West and North West Cambridge.
- Three distinct spaces are created: Upper Square (vehicular arrival drop off), Lower Square (student circulation) and East Pond (pedestrian arrival point from the city centre).

Surrounding land uses

- East Forum is a focus for shared facilities - located directly on the spaces are potentially, a canteen, a shared lecture theatre (potentially up to 500 seats - subject to further studies), other smaller lecture theatres, a library, as well as the potential for cafés and shops.
- These key shared facilities are located within two new buildings the Northern and Southern Forum Buildings.
- An Innovation Centre is located on the Upper Square.
- The spaces are a key gateway to the academic areas that lie to the north and west.
- An important visual link is established from the Upper Square towards The Green open space (JJ Thomson Garden) and the new Cavendish III Laboratory and Shared Facilities.
- Expansion spaces for the Department of Engineering provide new frontage and activity to The East Pond allowing this existing space to be an integral part of the new public realm.

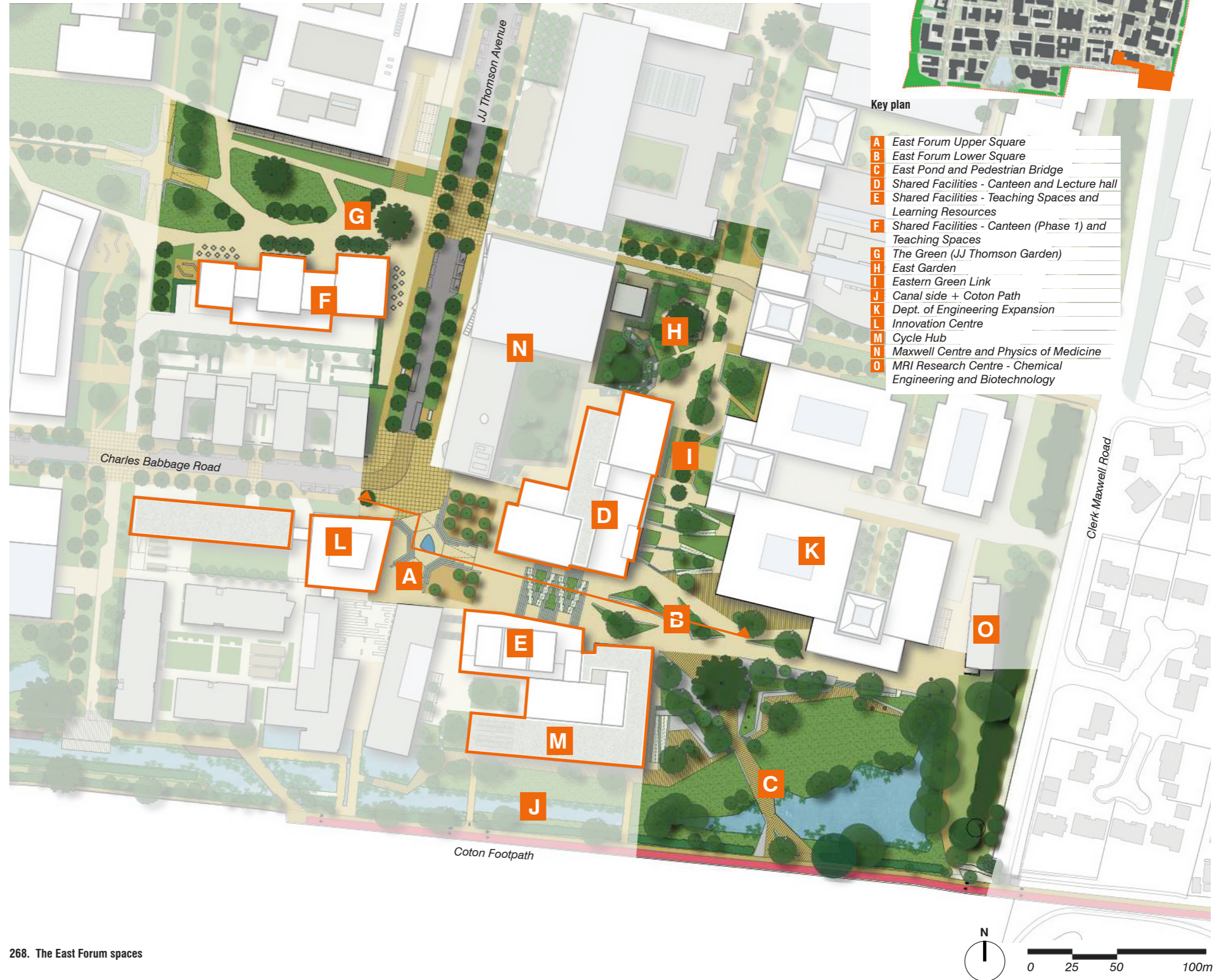

Movement

- The East Forum spaces are pedestrian priority spaces, envisioned as a series of connected spaces that link the Cotton Footpath, East Pond, JJ Thomson Avenue and Charles Babbage Road.
- Cyclists are restricted and vehicular traffic not permitted: a key cycle hub is located to the south of space accessed from the Cotton Footpath - one of the places within the masterplan where cyclists can dismount, safely store their bicycles and continue into the site as pedestrians.



Key plan for section



270. Bailey Plaza of Cornell University by Michael Van Valkenburgh Associates

Open space being scaled by landscaped green islands, slopes and steps. The direction of paving material accentuates and highlights the plaza acting as a key open space of academic interaction.



271. Steps and Terraces of Kyusgu Shango University by Fukuoka-based landscaping company Design Network

Stepped terraces and steps forming an amphitheatre and outdoor gathering space for students.



272. Erie Street Plaza in Wisconsin, USA by StossLU architects illustrating interspersed soft landscape and tree planting zones within paved circulation

Soft landscape can be interspersed with hard paving so as to scale down or articulate a space but at the same time ensuring necessary pedestrian circulation and movement.

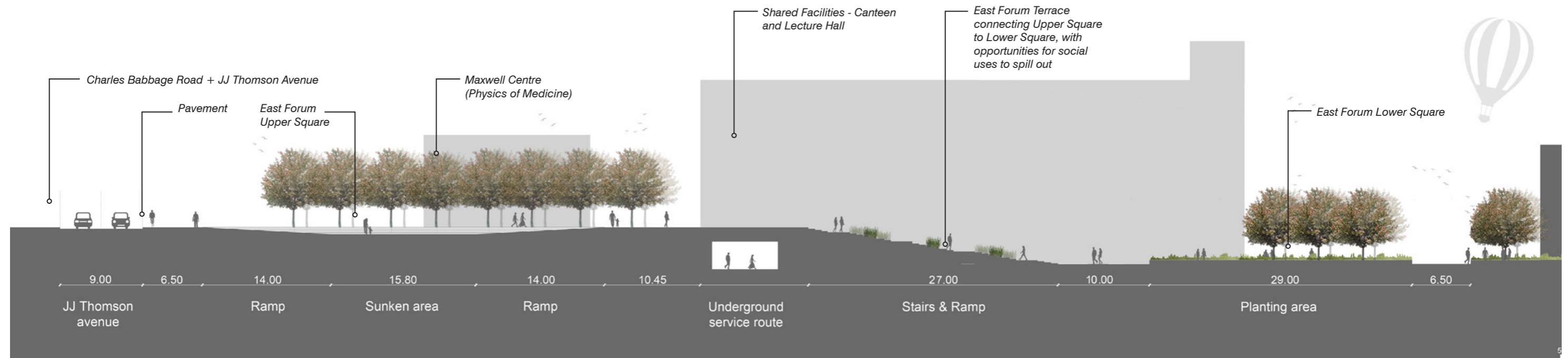

269. The East Forum - section



Key plan for views

Description of East Forum spaces

8.1.5 Like the West Forum, East Forum is a sequence of spaces, which negotiate the topography at this part of the site, with each of the spaces on different levels stepping down from the Upper Square to the Coton Footpath.

- The **Upper Square** is an active urban and social space with informal meeting areas and potentially a vehicular drop off.
- The **East Forum Steps** are a series of landscaped steps and ramps that connect the Upper and Lower Squares.
- The **Lower Square** is the revitalised green space that incorporates the existing East Pond and connects the Forum spaces directly to the Coton Footpath.

Scale of Spaces

8.1.6 Each of the spaces in the sequence forming the East Forum has been scaled in accordance with the envisioned character and purpose, and tested against relevant precedents.

8.1.7 The East Pond area is approximately 130x80m, providing space for the existing pond plus a green area for relaxation. This space is open towards the south so it borrows open views from the agricultural lands.

8.1.8 The length of the East Steps and Upper Square combined is around 120m, with Upper Square being around 60x60m. Such a size provides a more protected, defined space which is suitable for interaction and gatherings.

8.1.9 The Sidgwick site provides an example of academic buildings clustering around a series of walkable spaces.

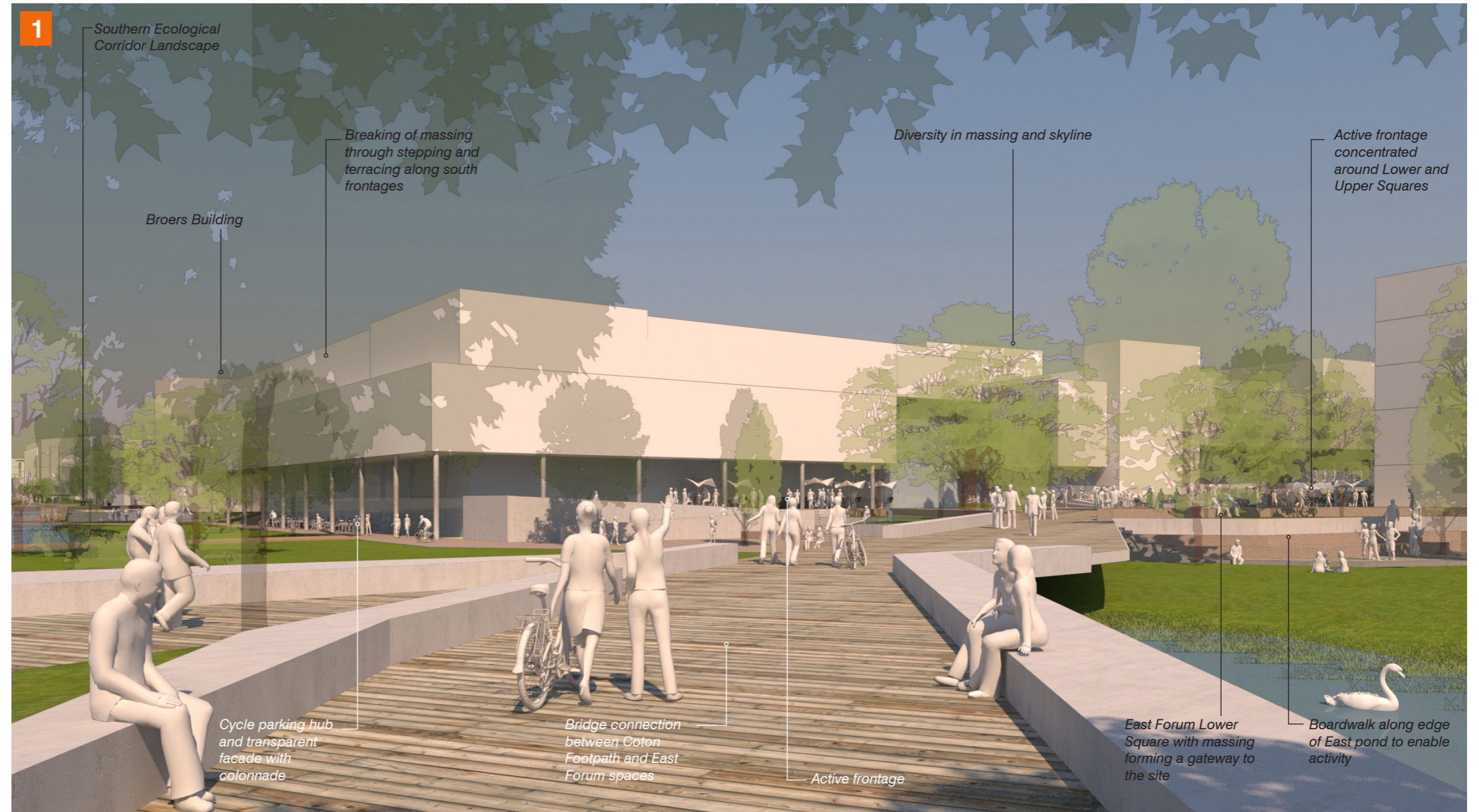

273. East Forum spaces: East Pond and southern gateway - view towards the East Forum from the Coton Footpath

The natural setting forms a serene arrival space for cyclists and pedestrians from the city centre. The views across the East Pond to academic life are framed by built form and landscape. This view shows how landscape elements could frame pedestrian circulation and guide it towards the East Forum.





Key plan for views

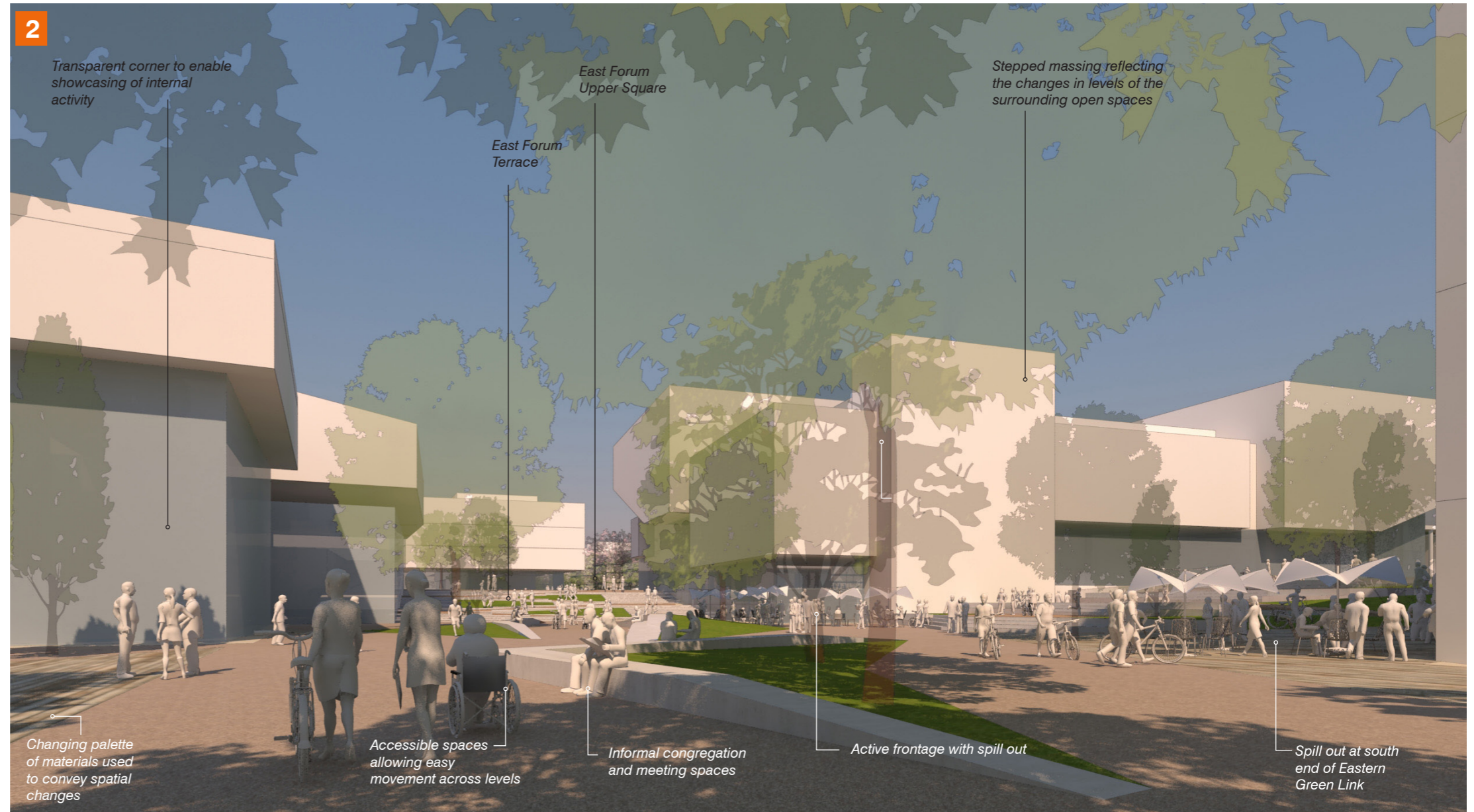

274. East Forum spaces - East Forum Lower Square



Key plan for views

Spatial sequence

- The existing East Pond is opened up and views allowed from Coton Footpath into a revitalised green space and the rest of the East Forum spaces.
- Key buildings form new active frontage that face south over the green space and East Pond. This provides active frontage and footfall through the space.
- A new pedestrian bridge over the East Pond provides a key link between the Coton Footpath and the East Forum spaces.
- The East Forum Steps connect the two main East Forum spaces, using the existing level change to provide interest and identity in this space.
- East Forum Lower Square will have highly active frontages and entrances to key uses such as the canteen and shared facilities.

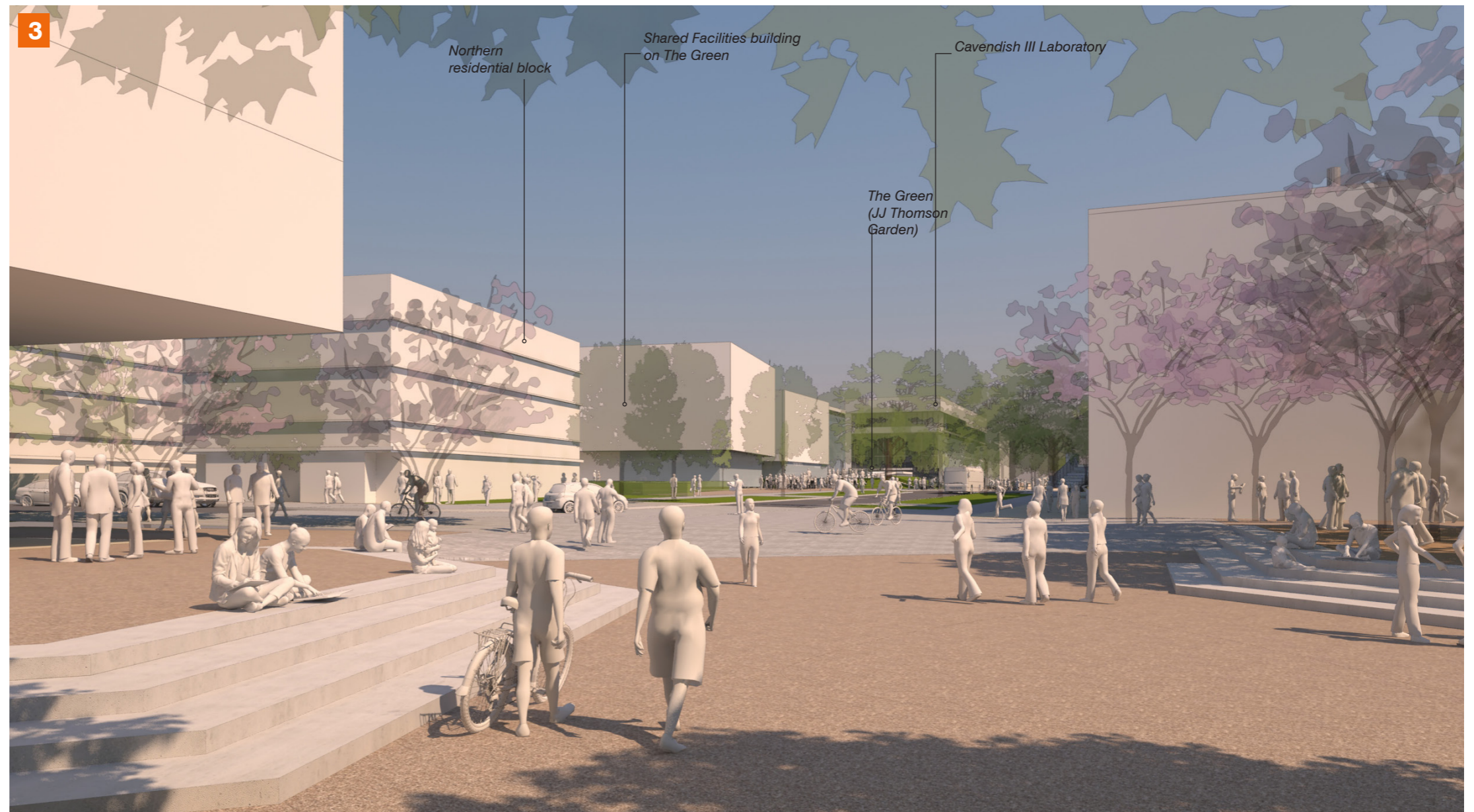

275. East Forum spaces: Upper Square, view towards The Green and the new Cavendish III Laboratory

This view shows that the open space of The Green (JJ Thomson Garden) and a prominent corner of the Cavendish III Laboratory are visible from The East Forum Upper Square enabling these spaces to be visually connected and strongly link the site together.

The Green

8.1.10 The Green will provide much of the open space for informal recreation and contains one of the primary cycle and pedestrian linkages across the site. The Green is formed of a chain of Gardens, which together form a visual corridor that links east to west across the site and captures the views towards City Centre as well as the Listed Schlumberger Research Building, providing a new prominence for its characteristic roof line.

Character

8.1.11 The Green forms a strong east/west aligned open space formed by the proposed development. The positive visual and physical relationship between the built edges and the Green open space enables higher levels of natural surveillance. The east-west pedestrian and cycle link is aligned to strong desire lines and itself will generate activity and animation within the space.

8.1.12 A series of 'social hubs' can be created at the intersections with the north-south routes.

Materials

8.1.13 As The Green occupies an area of existing open meadow, the intent is to maintain a similar visual experience but to add variation and visual variance to the ground plane with native planting suitable to create enclosure and controlling the micro climate. Existing trees will be retained and new tree planting will be added to reinforce movement corridors, vistas and focal points.

8.1.14 The Green will be predominately soft. Permeable paving will be used to minimise run off and where run off does occur it will be collected within bio-retention areas where possible for distribution to the wider surface water network.

8.1.15 The Green intersects and overlays with the existing streets JJ Thomson Avenue and High Cross. These points of intersection inspire a change in character and the streets move to a more pedestrian orientated environment, also serving to slow traffic and prioritise pedestrians.



276. The Green - section



277. The Green - aerial view looking west



278. The Green - plan

- A** Gateway
- B** Social Hub
- C** Green Links
- D** Open Lawn
- E** Shared Facilities/Social Spaces
- F** Pedestrian/Cycle Route
- G** Service courtyards
- H** Covered Cycle Parking
- I** Shared Surface to Crossings



279. Landscape Reference - the Agrarian Landscape



280. Social Hub aerial View

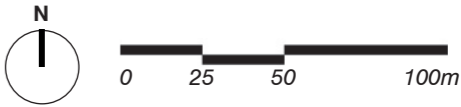

Key plan



Key plan for views

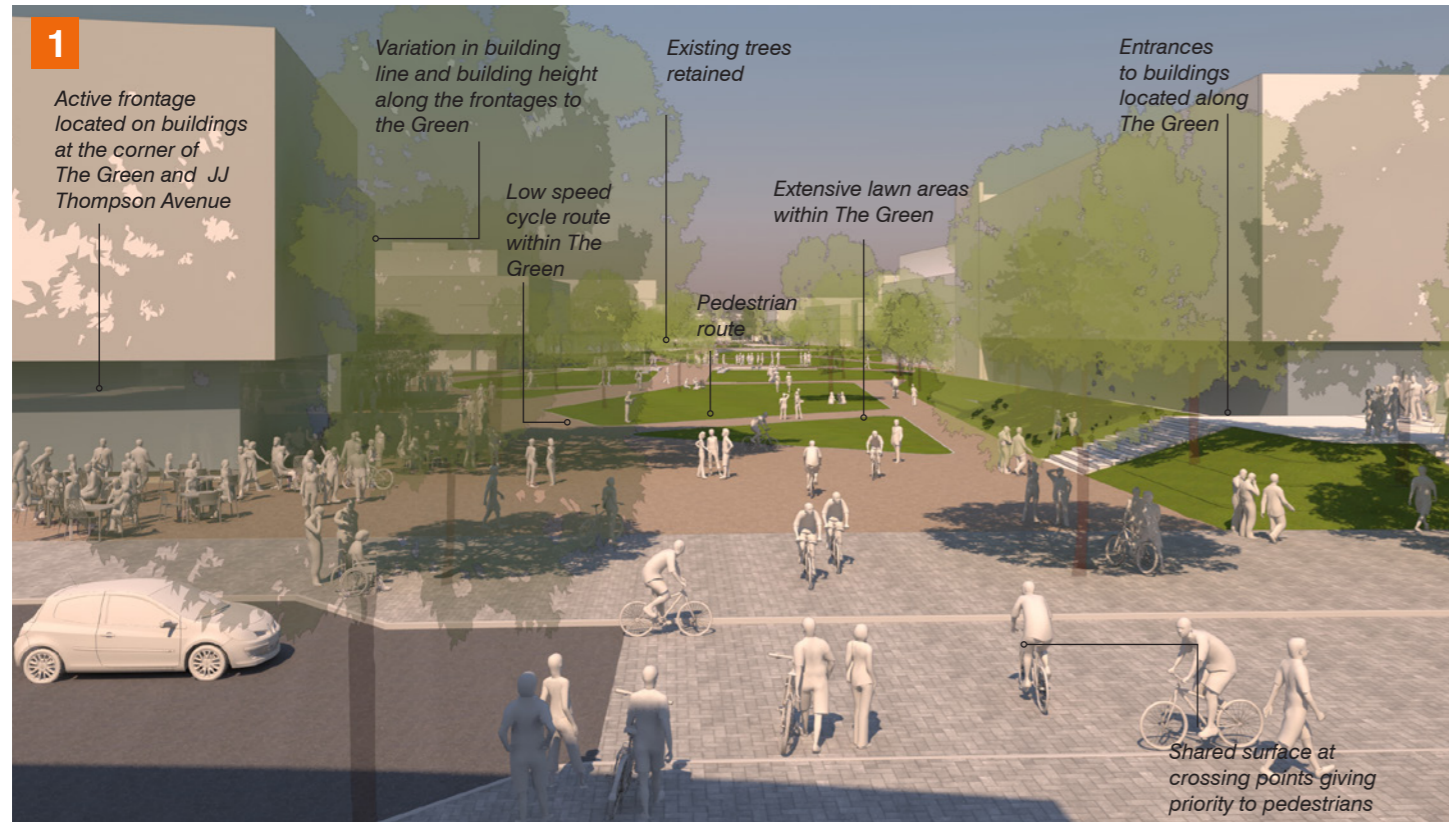

281. The Green: View from JJ Thomson Avenue, looking towards the Schlumberger Research building, through The Green public open space.

The Green forms a series of connected Gardens that are shared by the campus. This green space forms a key east-west pedestrian and cycle link and the presence of this plus other social spaces ensure that it will be a vibrant space. This space will be shared by various academic departments and commercial occupiers alike.

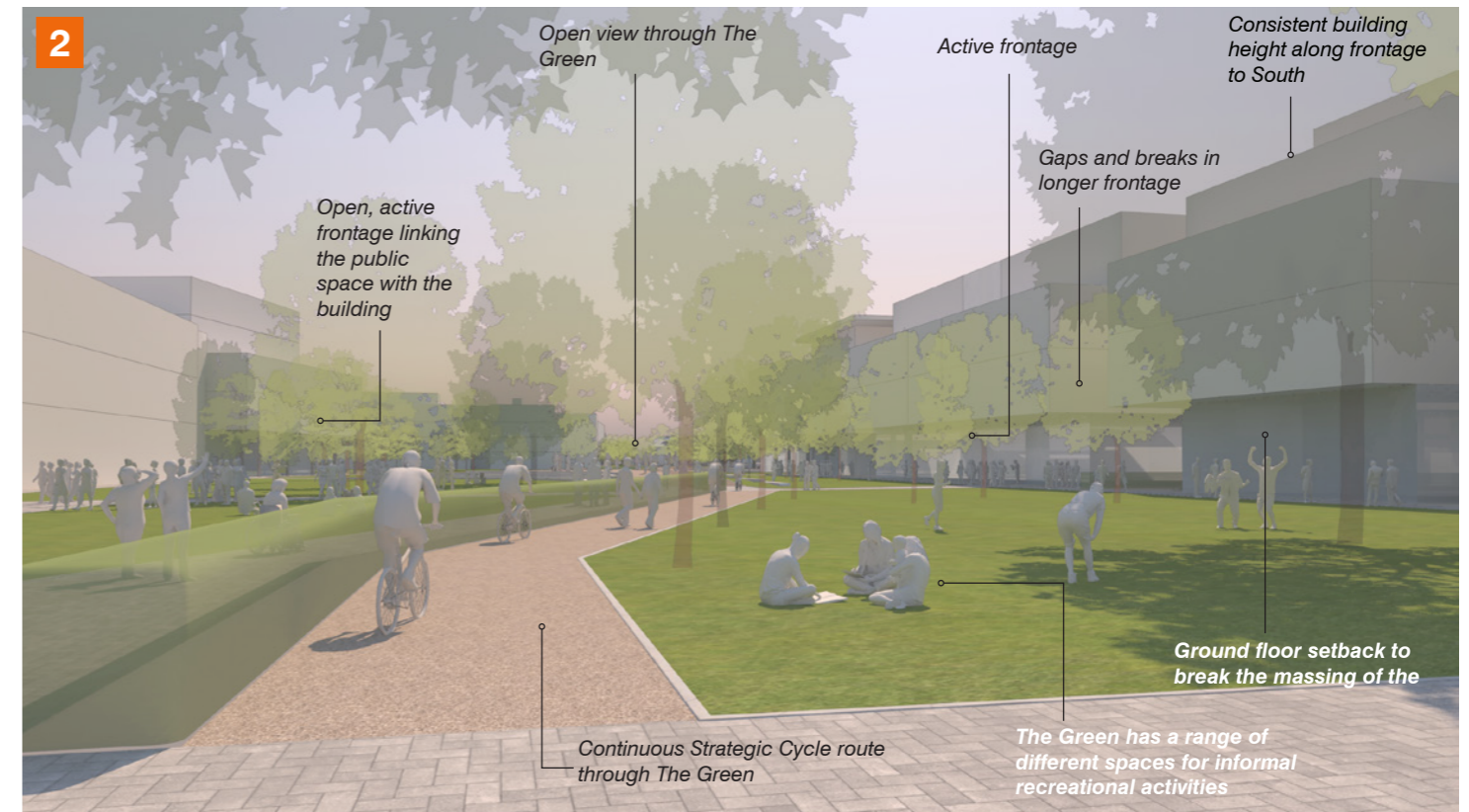

282. The Green: The Green viewed from High Cross, looking east.

The Green forms a central open space providing a space for relaxation, reflection, informal interaction, spill-out and event space

Key elements

- The Green is made up of a series of four Gardens, with key space being the Central Garden. This space provides a major landscaped, open, green space in the heart of the masterplan and retains and incorporates the mature, existing trees located within this part of the masterplan;
- The other Gardens are High Cross Garden, JJ Thomson Garden and East Space.

Surrounding uses

- Development surrounding The Green forms frontage and provides overlooking to The Green. Smaller social spaces and building entrances are located along this space at ground floor, to ensure animation;
- A mixture of academic and commercial floorspace: this is one of the key areas of interchange and collaboration between the two use types;
- A new, early phase major Shared Facilities Hub provides activity onto JJ Thomson Garden;
- Additional academic uses to the east of the space reinforce the eastern academic cluster, and provides a new home for the Physics Department - the Cavendish III Laboratory;

- The Cavendish III Laboratory is a key new building that forms frontage along The Green. This building is also visible from the East Forum, visually connecting and drawing activity and footfall between these two spaces;
- The Schlumberger Research Building is located to the west of The Green. This building may eventually be supplemented by future expansion which will form new frontage and potentially, visually expand The Green west-wards. In the illustrative masterplan, proposed development is arranged to frame a new forecourt with a new address and drop off for Schlumberger at High Cross;
- Car parking and servicing is located away from The Green, to the north. In addition, cycle parking is located outside of The Green but close by within the adjacent Green Links.

Southern Ecological Corridor

8.1.16 The Southern Ecological Corridor will be retained and reinforced to form a strategic green connection and cycle link between the City and the countryside. It will incorporate the existing Coton Footpath, the existing canal, water bodies and existing landscape features to maintain and enrich the biodiversity which has already been established.

8.1.17 Along this Southern edge of the site the Canal will be enhanced and will be a key element in the site-wide sustainable drainage system. To the west of West Lake, the Corridor will incorporate the existing mature Oak trees and swale.

Character

8.1.18 Additional planting is proposed within the Southern Ecological Corridor to establish a protected micro-climate and mitigate the visual impact of the proposed development. The existing water bodies will need some modification to accommodate additional surface water run-off from the wider network proposed within the masterplan.

Materials

8.1.19 Existing mature trees will be maintained and augmented where possible. A coordinated street furniture palette will be developed that is visually relevant to the wider public realm setting whilst also takes design cues from the naturalistic setting of the waterside character.

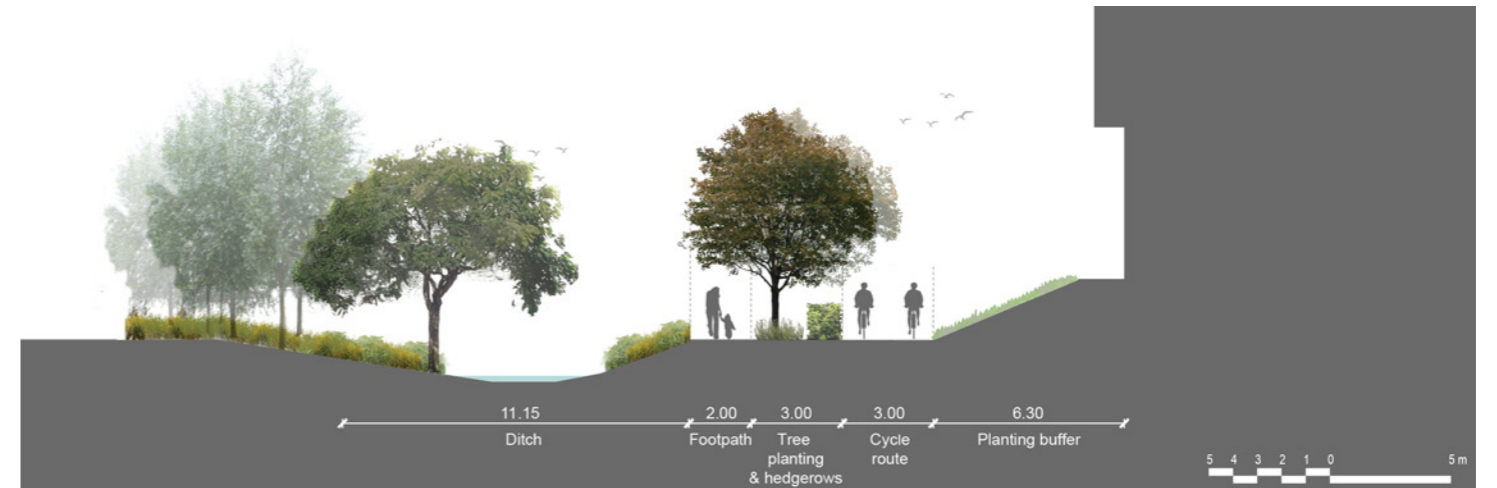

284. Southern Ecological Corridor - section



283. Southern Ecological Corridor - plan

Key plan



Key plan for views

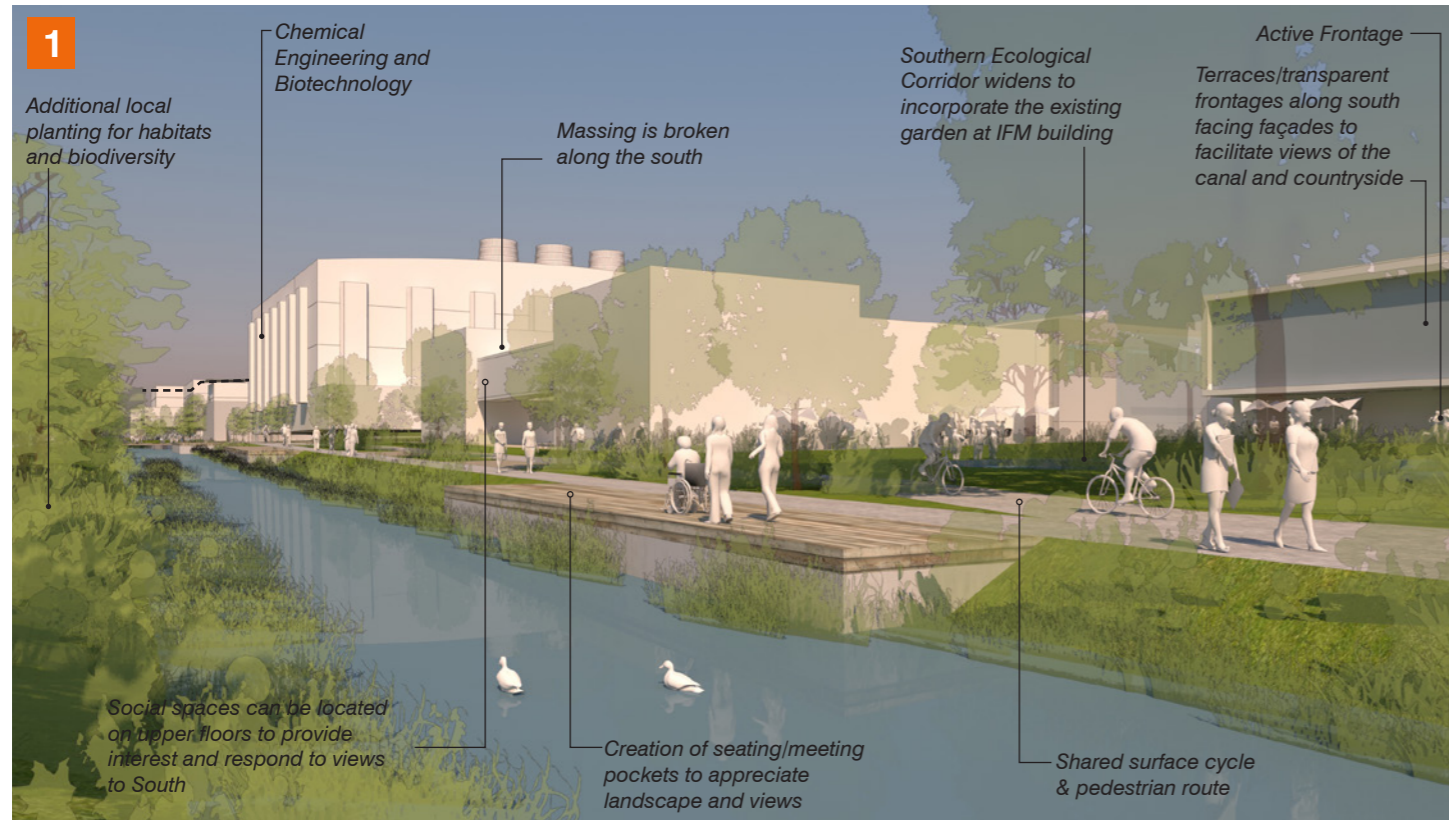

285. The Southern Ecological Corridor: Frontage to the Southern Ecological Corridor looking towards the West Forum

The canal-side Southern Ecological Corridor is a key cycle and pedestrian path which extends the Coton Footpath through the site. The Southern Ecological Corridor is also designed to be quiet and reflective in nature.

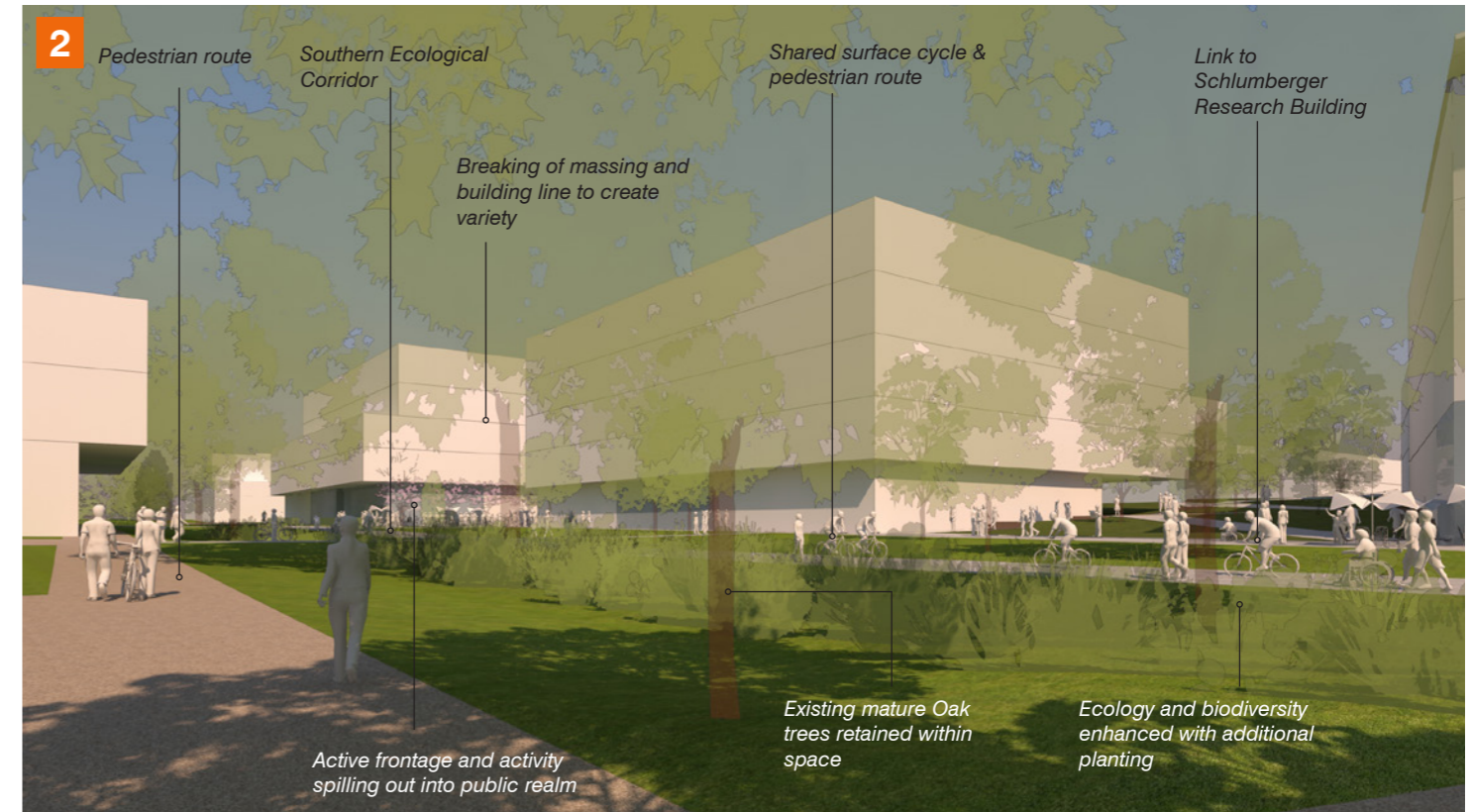

286. Southern Ecological Corridor: within the Western Commercial Cluster

The Southern Ecological Corridor at the western end forms a focus for activity within the Western Cluster. A predominantly green space, this incorporates existing mature trees with additional planting. Buildings form and informal frontage to the space and ensure activity and overlooking.

Surrounding Uses

- Existing buildings and new infill (academic and commercial) developments will form frontage to the Southern Ecological Corridor.
- A large cluster of commercial research space at the western end of the Southern Ecological Corridor, will provide a frontage with entrances and points of activity.
- The existing Sports Centre and its future expansion, which is a key destination within the masterplan, will draw visitors through the space, both during the week and in the evenings.
- New frontage with additional activity along the Southern Ecological Corridor ensures overlooking.
- New development frontage also provides a new urban character for Charles Babbage Road which will incorporate new primary frontage with building entrances along its length.
- New development contributes to the formation of a new Southern gateway to the site along the Coton Footpath at the East Pond.

8.2. Streets and Green Links

High Cross

8.1.20 High Cross is the main entry road to the site and is the main link from Madingley Road to West Forum and Charles Babbage Road. The intent is to create a main gateway and tree lined boulevard that welcomes visitors into the site.

Character

8.1.21 The road will have one character all along its length however this character will change in two instances; where High Cross intersects with the Green and the West Forum. The street will adapt to the character of these open spaces by becoming a shared surface with additional planting in the case of the Green, and a shared surface crossing for the West Forum at the second intersection. The road will be characterised by the existing rows of trees and new under storey of planting. Additional trees will be introduced to break up the ridged tree planting and bring the continuation of the landscapes in the North West Cambridge Development through to the West Cambridge site.

8.1.22 The width of the road will remain the same with the addition of a change in paving at the shared surface crossing points and vertical markers to narrow the street and to create a pedestrian/cycle friendly, low speed environment. A series of planted rain gardens will be included where possible responding to the limited space between the existing trees and underground services. Swales will collect carriageway water runoff and act as points of interest and reduce the visual dominance of the road.

Materials

8.1.23 A foundation palette of street furniture, lighting and paving elements is defined to deliver unity along the street and where possible, existing lighting and street furniture will be retained or reused in new locations. Existing trees will be retained wherever possible.

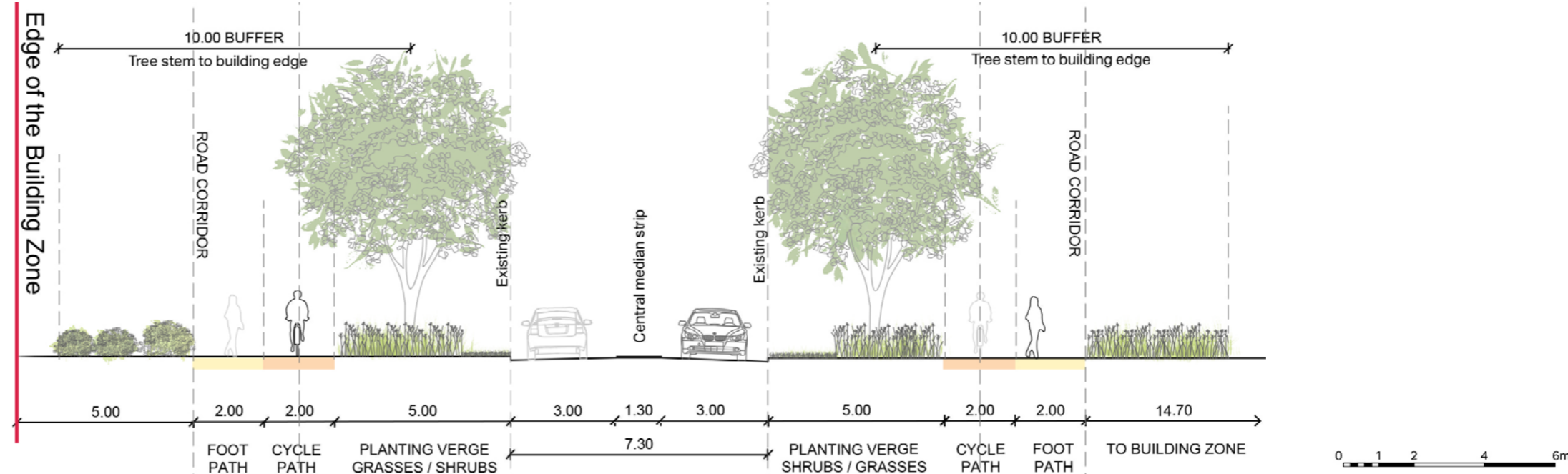

287. High Cross - Section

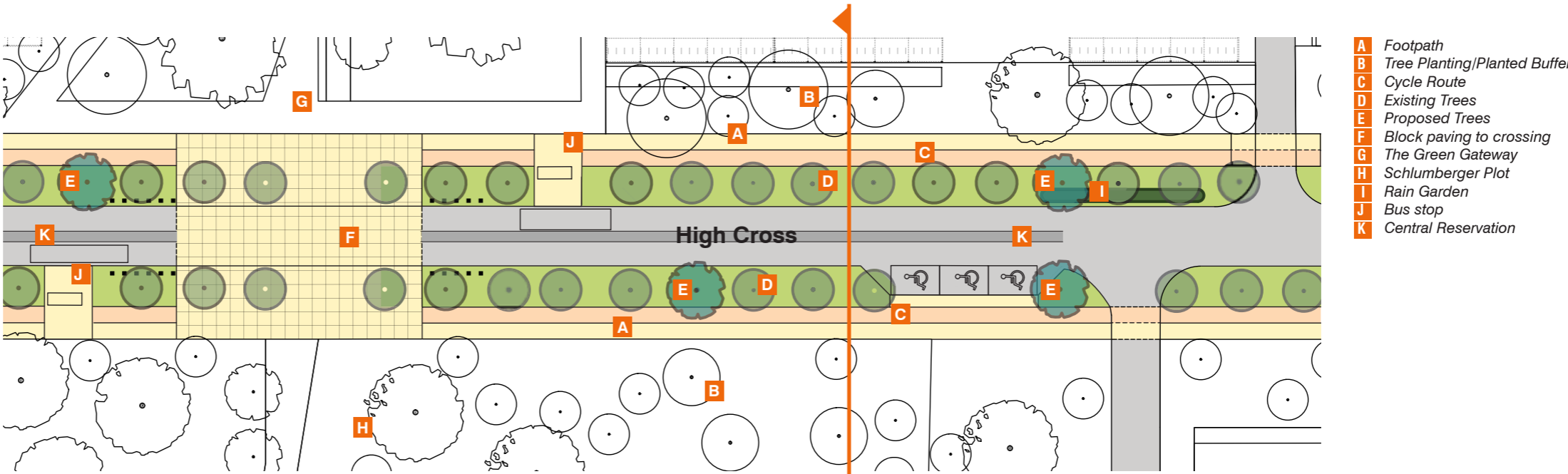

288. High Cross - plan



Key plan

JJ Thomson Avenue

8.2.1 JJ Thomson Avenue is the second entry road to the site. It is the main link between Madingley Rise and Madingley Road and the East Forum spaces. The intent is to create a tree lined boulevard and gateway into the site.

Character

8.2.2 JJ Thomson Avenue will be characterised by the existing rows of trees and new under storey planting. The pedestrian crossings are a shared surface paving to facilitate pedestrian movement.

8.2.3 The Avenue will have one character all along its length however this character will change in two areas when the Avenue intersects with the Green, and when it intersects with the East Forum. In these two instances the street character will adapt to the character of these open spaces by becoming a shared surface that has additional planing in the case of the Green, and a shared surface link at the East Forum at the second intersection.

8.2.4 The width of the Avenue will remain generally the same. The existing bus stops will be retained on-street to pick up and drop off passengers and the street profile will be changed in places to allow for on street parking spaces.

Materials

8.2.5 A foundation palette of street furniture, lighting and paving elements is defined to deliver unity along the Avenue and where possible, existing lighting and street furniture will be retained or reused in new locations. Existing trees will be retained where ever possible.

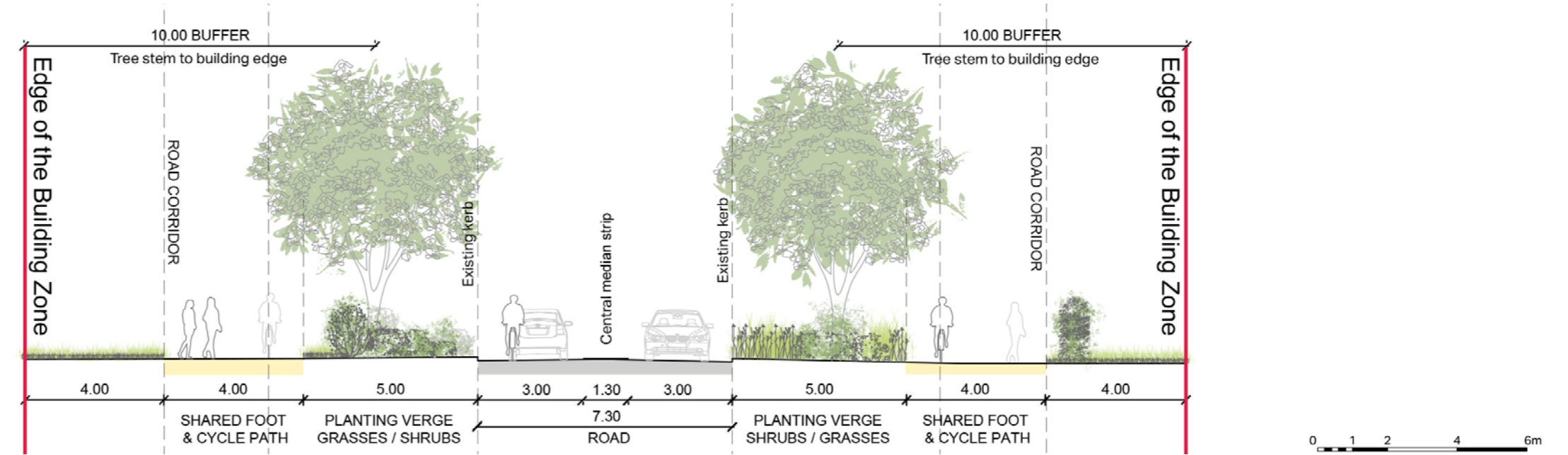

289. JJ Thomson Avenue - Section

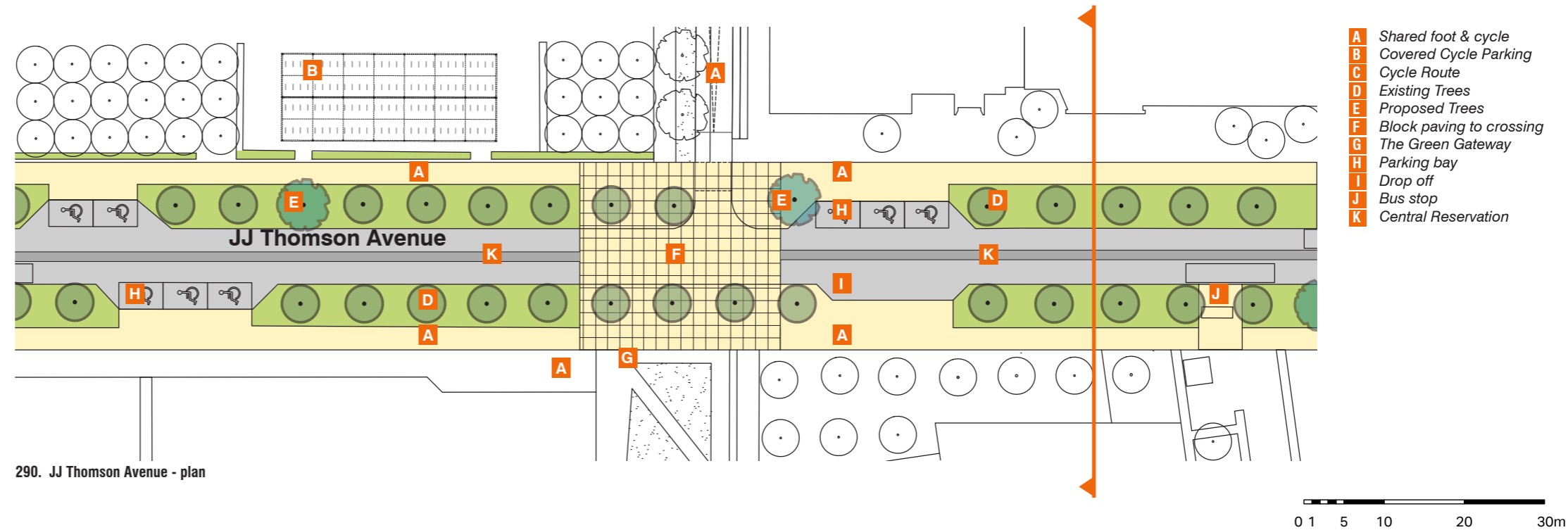

290. JJ Thomson Avenue - plan



Key plan

Charles Babbage Road

8.2.6 Charles Babbage Road will act as a new Forum Link connecting the two key points for arrival and activity within the site, the East and West Forum. The current form of the Road is a formal avenue with a single species of tree, and the intent is to introduce a playful and informal structure reducing the scale of the road, and to reflect the range of uses and crossing points along the street.

Character

8.2.7 The Road has been divided into several distinct areas of character relating to the associated land use; reflecting where arrival points occur; where activated frontages are located; the location of bus stops and on street car parking; and the location of drop off points.

8.2.8 The principal initiative of the design strategy defines character zones by varying tree species and planting which will augment the existing tree design. The public realm will also be enhanced by the introduction of bio-retention rain gardens, creating pocket landscapes along the street, whilst maintaining permeability for pedestrians to freely cross the road.

8.2.9 The width of the Road will remain the same, but with the addition of a change in paving at shared surface crossing points and vertical markers to create a pedestrian/cycle friendly, low speed environment.

Materials

8.2.10 A foundation palette of street furniture, lighting and paving elements is defined to deliver unity along the road and where possible existing lighting and street furniture will be retained or reused in new locations. Existing trees will be retained wherever possible.

8.2.11 Crossing points will not be raised tables, but will be noted with a change of surface material to reduce traffic speed and create a shared surface.

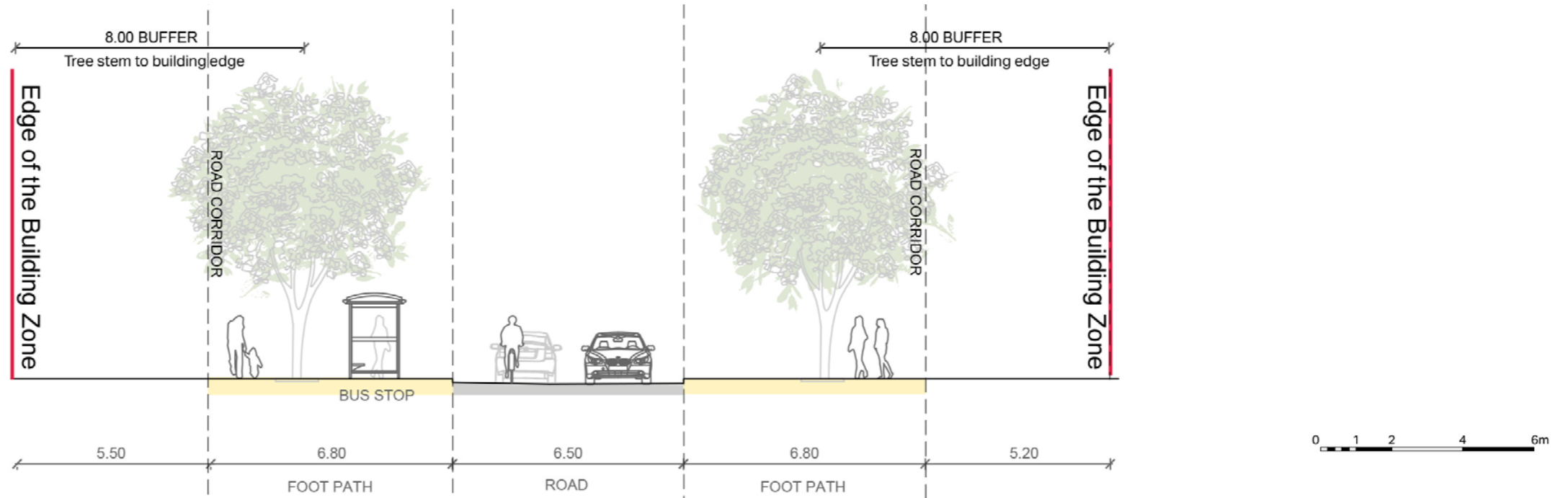

291. 241. Charles Babbage Road Section

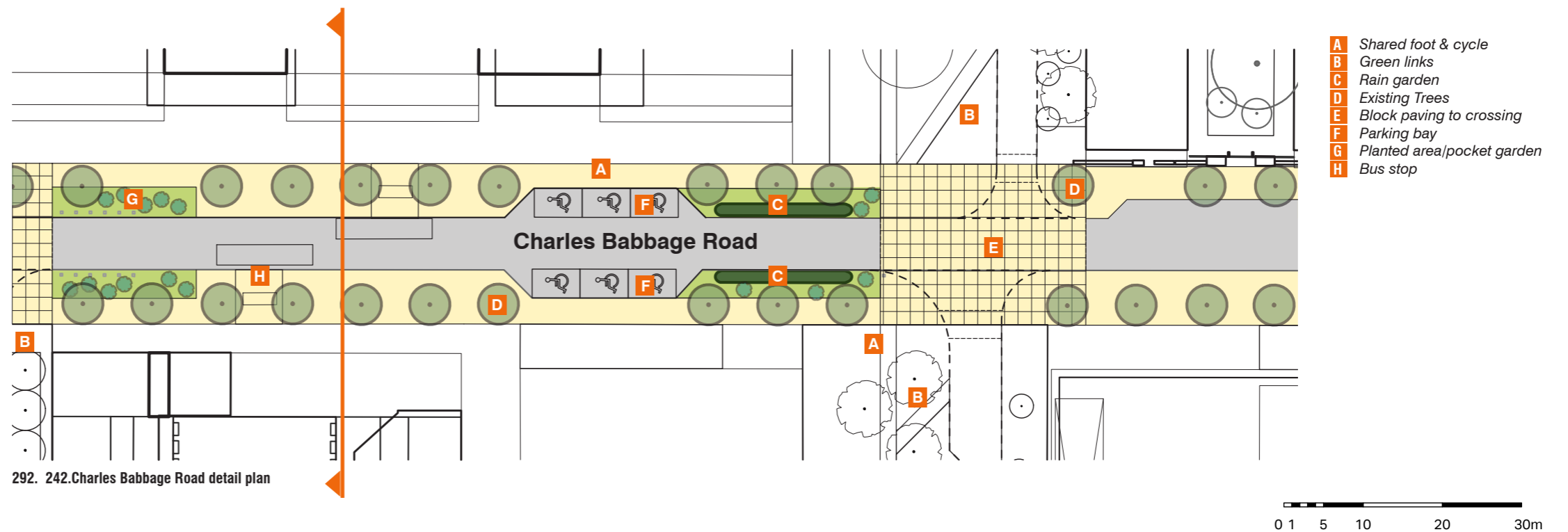

292. 242. Charles Babbage Road detail plan





Key plan for views



293. JJ Thomson Avenue Character Area - view along JJ Thomson Avenue, looking south to the East Forum spaces

The Green open space is prominent from JJ Thomson Avenue. The Cavendish III Laboratories form a strong frontage to the street and a prominent corner visible from The East Forum, enabling these spaces to communicate and create a strong link.

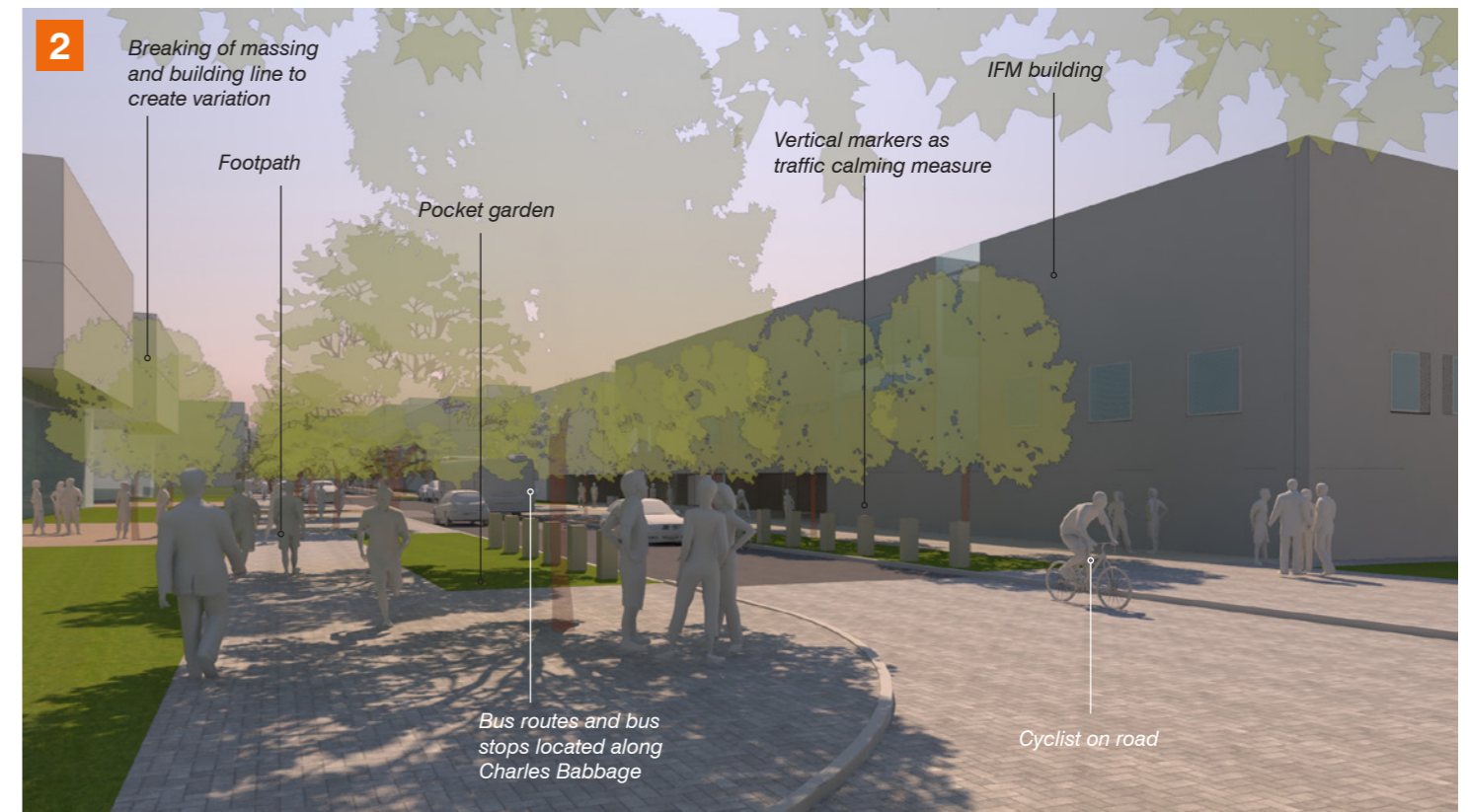

294. Southern Character Area: Frontage to Charles Babbage Road - view towards the East Forum

The view shows how landmark elements can highlight key pedestrian spaces and provide new enclosure to Charles Babbage Road, transforming it into a street with a more urban feel.

Western Access / Ada Lovelace Road

8.2.12 The Western Access Road will provide cycle and pedestrian access to the western side of the site from Madingley Road to the commercial cluster. A new access point will be provided in later phases of development.

Character

8.2.13 The width of the road will remain the same (5.4m to Western Access Road in the north and 6.5m to Ada Lovelace Road in the south) with the addition of a change in paving at shared surface crossing points.

8.2.14 The street will be characterised by the retention of the existing hedgerow on the eastern side of the street, at the boundary to the Schlumberger site. There will be the addition of low shrub planting along the street, (types of planting are limited by the existing underground gas main line and easement). However, the existing row of trees towards the south of the street will be maintained where possible.

8.2.15 To Ada Lovelace Road, the public realm will also be enhanced by the introduction of bio-retention rain gardens along the roadway where possible, to collect roadway run off.

Materials

8.2.16 A foundation palette to match the other roads will be implemented, unifying the road network whilst providing individual character.

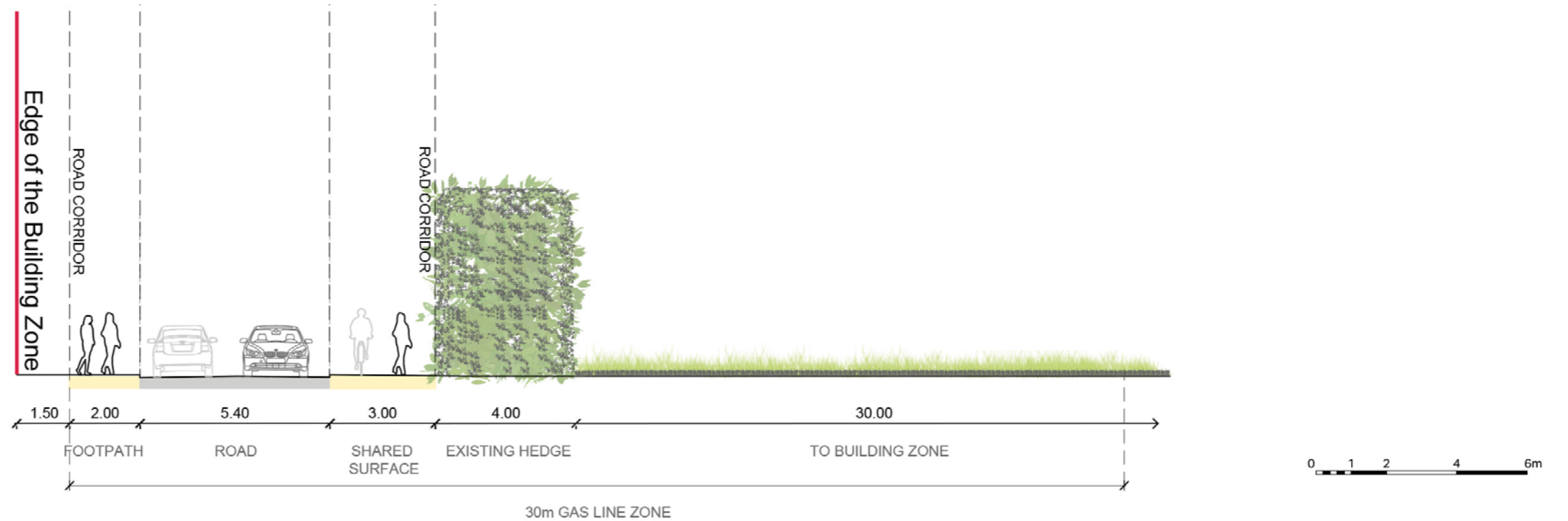

295. Western Access / Ada Lovelace Road Section

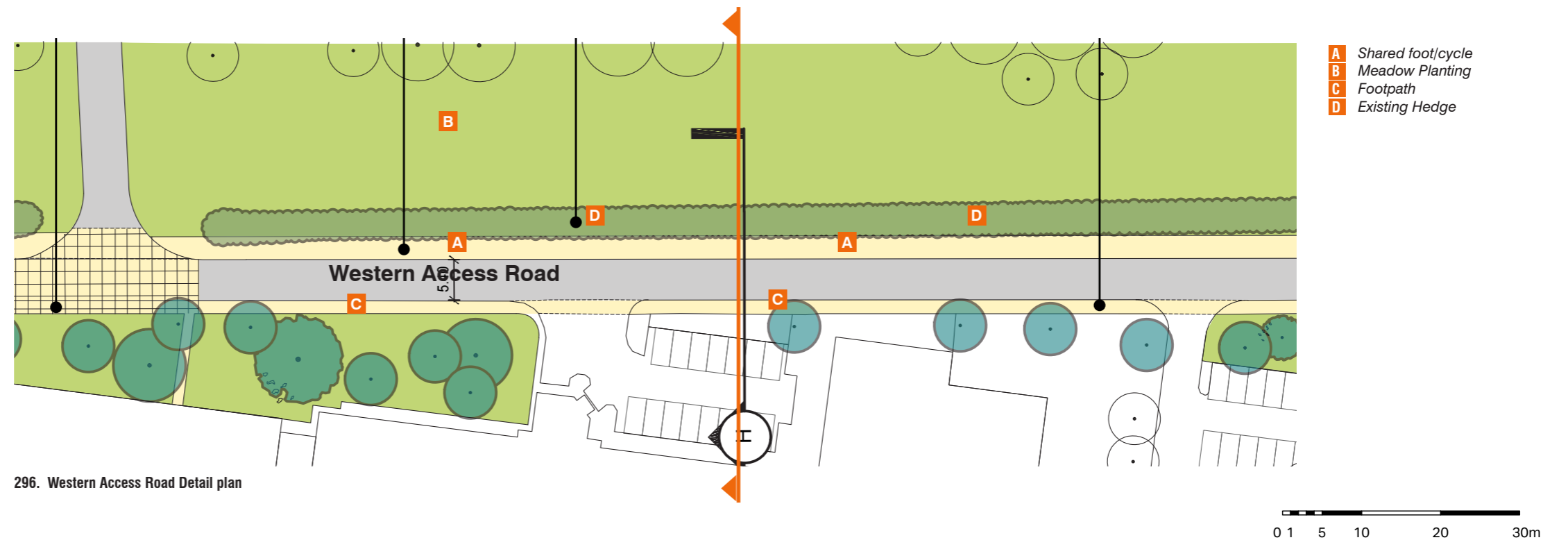

296. Western Access Road Detail plan



Eastern Green Link

8.2.17 The Link has origin in an existing service street which served both pedestrian and vehicular access to existing buildings and car parks. It is located between a series of existing academic buildings. Development of new academic and shared facilities buildings around the Link will transform this service street into a cohesive, more urban, pedestrian environment.

8.2.18 The Eastern Green Link will be one of the primary Green Links within the proposed masterplan. This pedestrian only space will form the main public realm element within the eastern, predominantly academic cluster where it is expected to draw a significant footfall.

8.2.19 In the southern part, the Link connects to the East Forum spaces and, from there, to the Cotton Footpath and the key pedestrian gateway in the south eastern corner of the site.

8.2.20 In the northern part, this Green Link joins with the Arrival Square, a public space which links to JJ Thomson Avenue and the vehicular gateway at Madingley Road.

Role in the masterplan

- A large part of the new academic space to be provided in West Cambridge is organised along this Link. At present this includes space for the consolidation of the Engineering Department at West Cambridge as well as retained related academic facilities such as the Computer Laboratory within the William Gates Building and the Maxwell Centre (Physics).
- This Link will be the key connective space for the Eastern cluster. Existing buildings, new academic uses and activities (such as waiting areas and informal space for interaction between students and faculties of various disciplines), can spill out into it.



Key plan

- To the north of the Green Link a landmark reception building for the Department of Engineering is located. This will be visible from JJ Thomson Avenue and will form frontage to the Arrival Square which will accommodate drop on/drop off for visitors and taxi's.
- At the point where the Eastern Green Link meets the The Green, East Garden, a primary focal space for the area, will be formed. From this space there will be pedestrian and cycle connection to the other spaces of the Green in the west and to Clerk Maxwell Road in the east;
- The East Garden is located centrally within the academic cluster and forms the first in a chain of gardens and spaces that form The Green open space that traverses the site from east to west;
- This framework allows for the incorporation of existing buildings, which can potentially be adapted to form frontage to this space, and potentially add entrances and/or active uses, either through reconfiguration of existing buildings or addition of elements.

- A Arrival Square and Reception Building
- B Eastern Green Link
- C East Garden (part of The Green)
- D Shared Facilities Building
- E Later phase academic development
- F Multi storey car park
- G New development
- H Computer Science extension
- I Whittle Laboratory retained and extended
- J MRI Research Centre - retained
- K Maxwell Centre and Physics of Medicine
- L CAPE Building - retained
- M Roger Needham Building - retained
- N William Gates Building - retained
- O East Forum - Lower Square

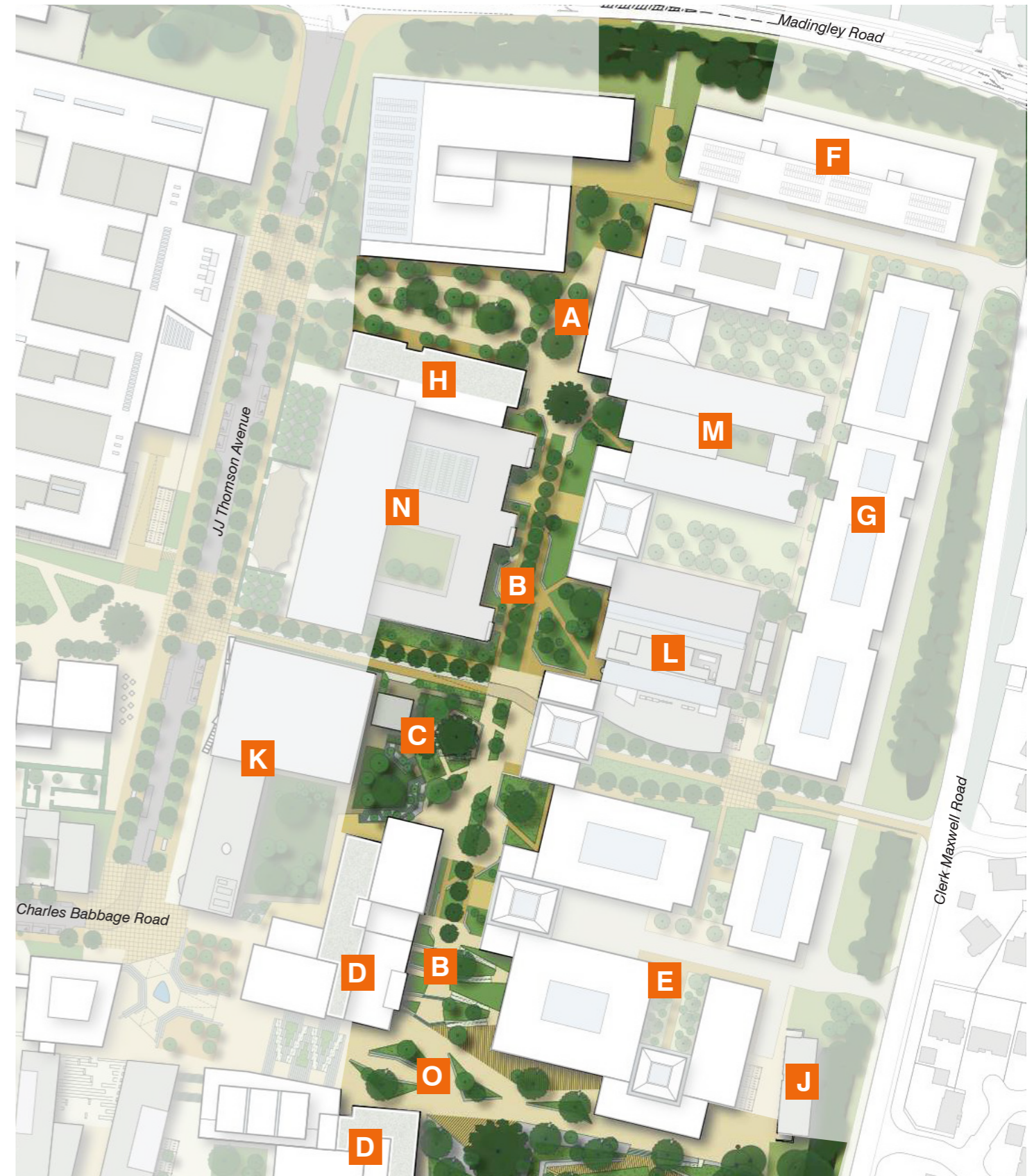
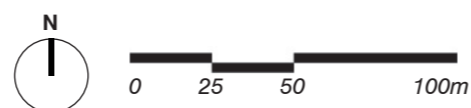

297. Eastern Green Link



Key plan for views

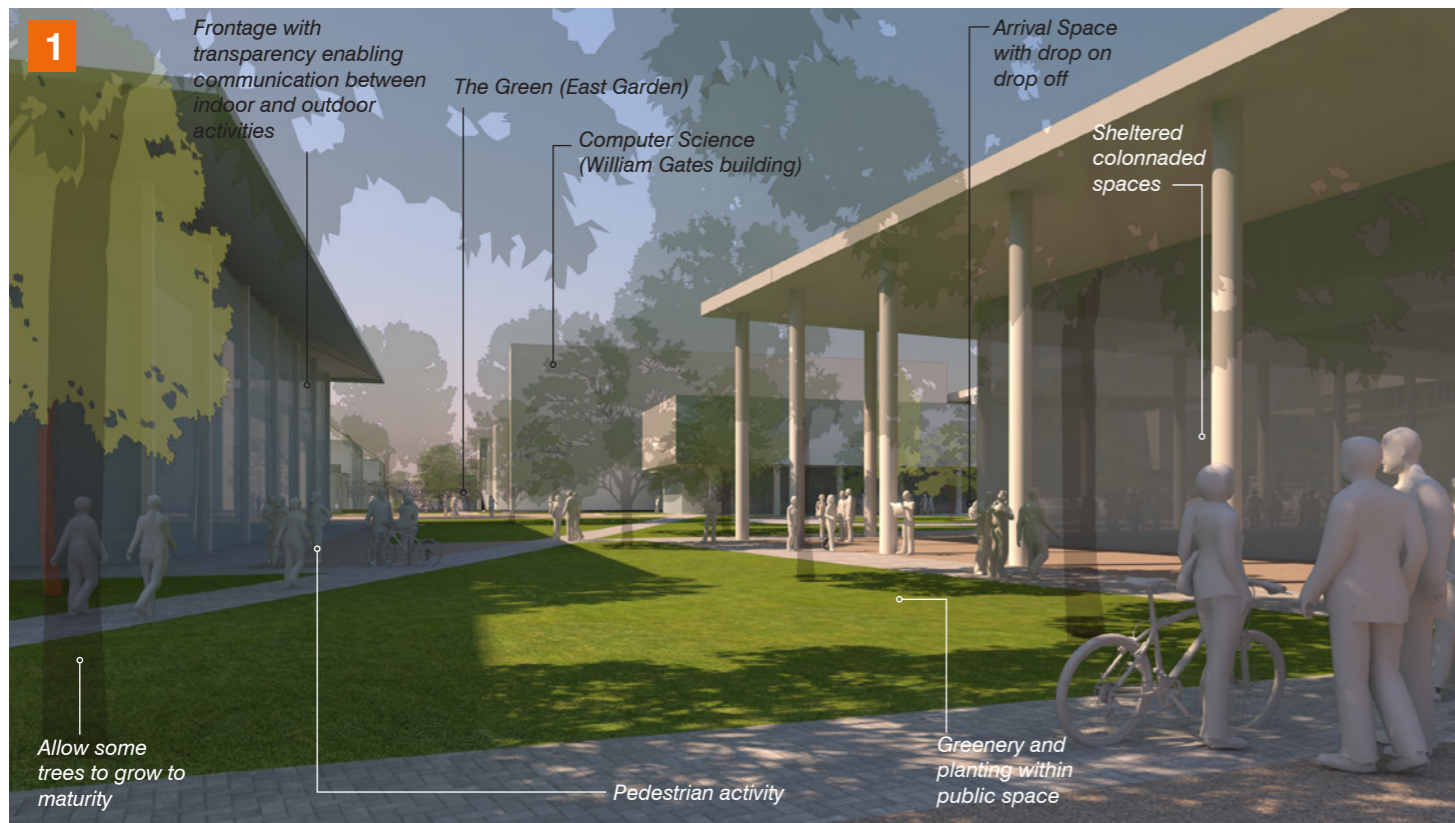

298. The Eastern Green Link - looking south towards the Arrival Square and the East Forum in the distance.

The Central Green Link creates a sheltered, pedestrian environment for academic buildings spill out into, for social interaction and most importantly circulation between the Arrival Square, the Green and East Forum spaces.

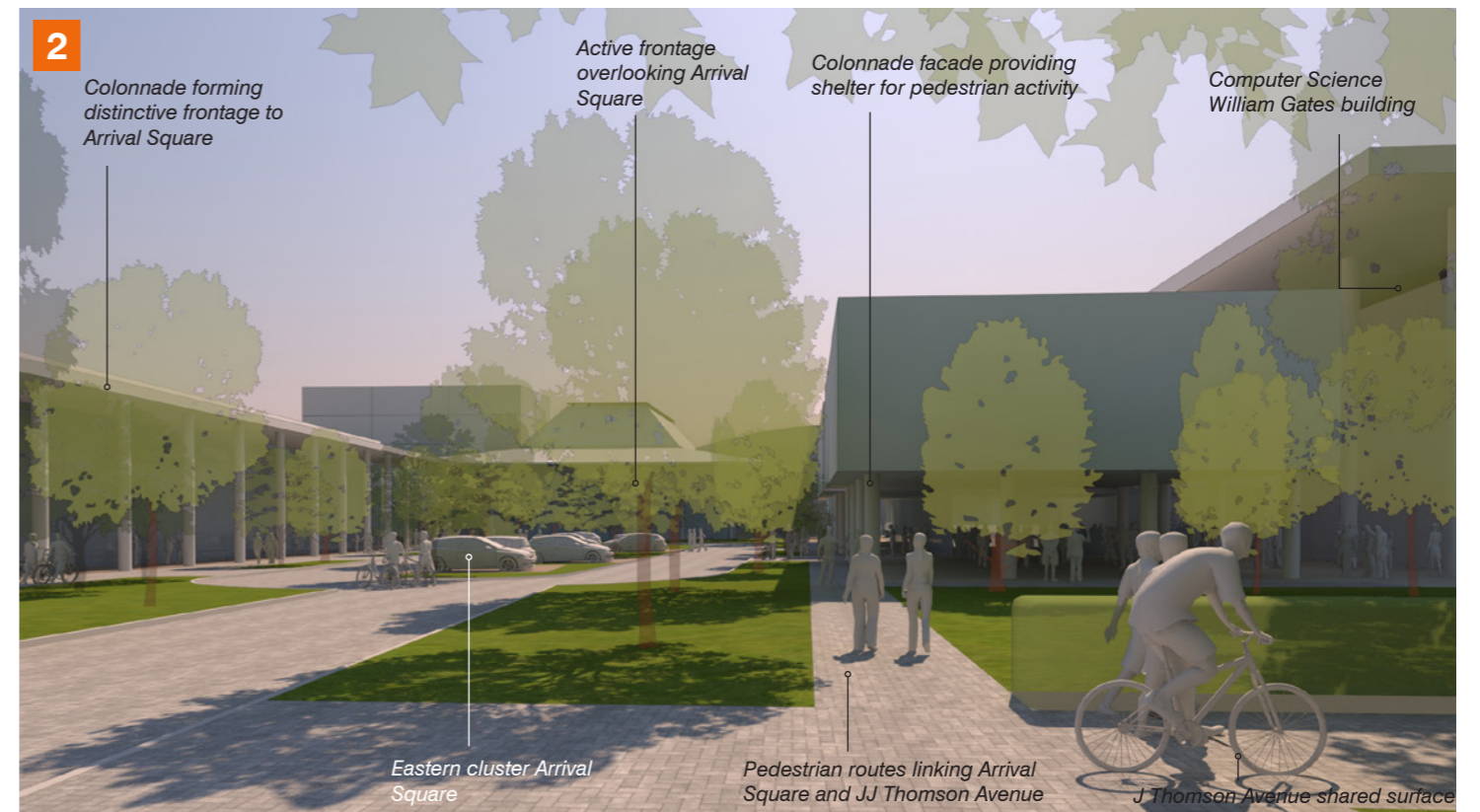

299. The Arrival Square as viewed from JJ Thomson Avenue.

Arrival Square and landmark reception building, act as a key arrival experience for visitors coming to the area.

Central Green Link

8.2.21 This Link is comprised of several existing spaces which the masterplan proposes to join and transform with new landscaping.

8.2.22 In the north, the Link is formed from the former Vet School approach, where it incorporates the existing mature lime trees. In the southern part, the Link is formed from the a current service access from Charles Babbage Road, which will be widened to allow for a landscaped corridor.

Role in the Masterplan

- This Link provides a site-wide north-south connecting space, between the Southern Ecological Corridor in the south to Madingley Road in the north, in a pedestrian friendly and landscaped environment;
- At the southern end, where the link meets the Southern Ecological Corridor, a widened area will be provided suitable for informal small gatherings and a space that will allow tree planting to grow to maturity;
- There will be no vehicular traffic crossing The Green (other than emergency vehicles where required), but in the north and the south of the Green Link vehicular access will be allowed to provide servicing to adjacent developments.



Key plan

- A Central Green Link
- B The Green
- C Cavendish III Laboratory
- D Shared Facilities Building
- E Potential Future Cavendish Expansion
- F Maxwell Centre - Physics of Medicine
- G New academic uses
- H Residential North Block
- I Residential South Block
- J Department of Engineering buildings
- K Innovation Centre

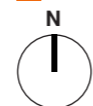

0 25 50 100m

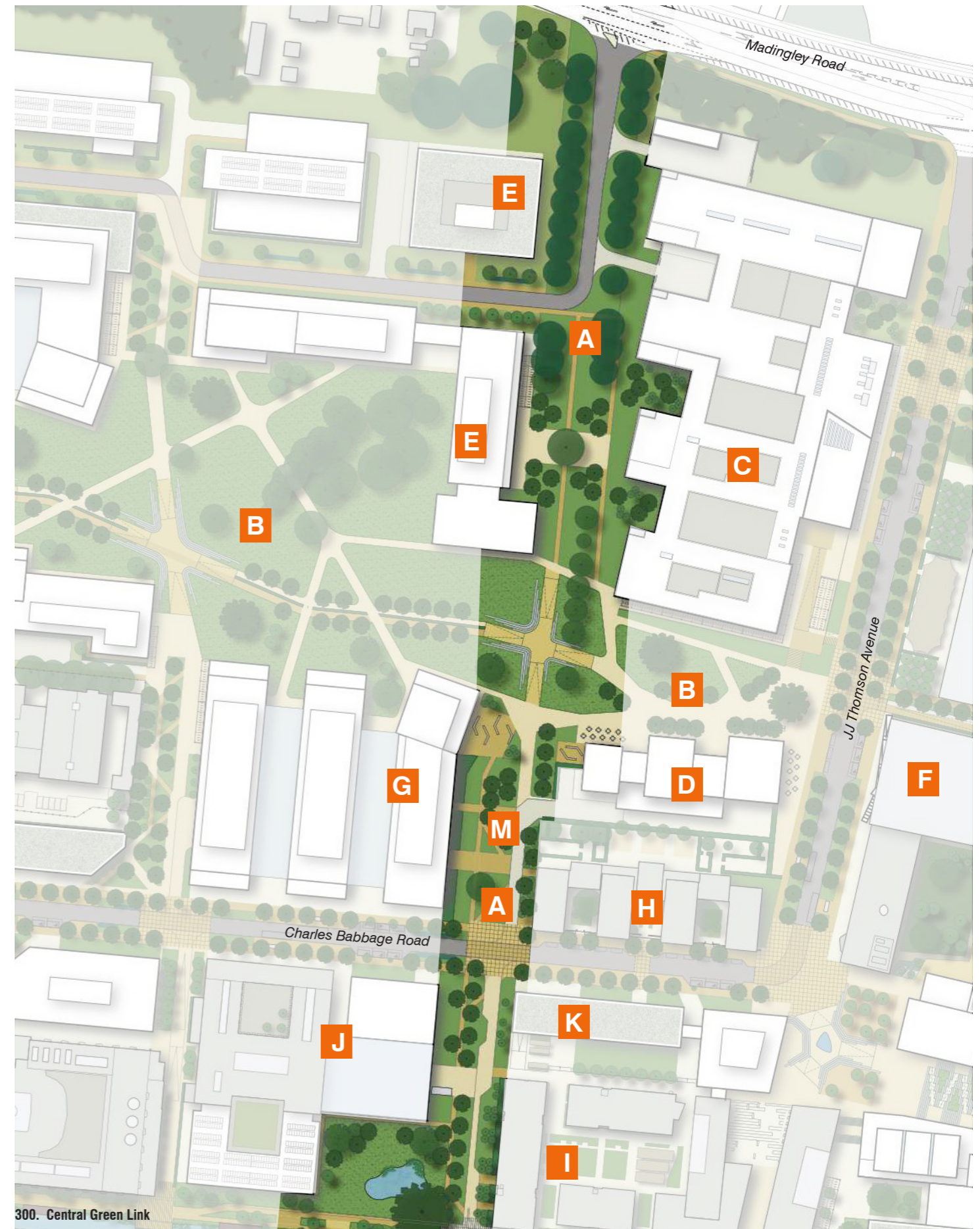

300. Central Green Link

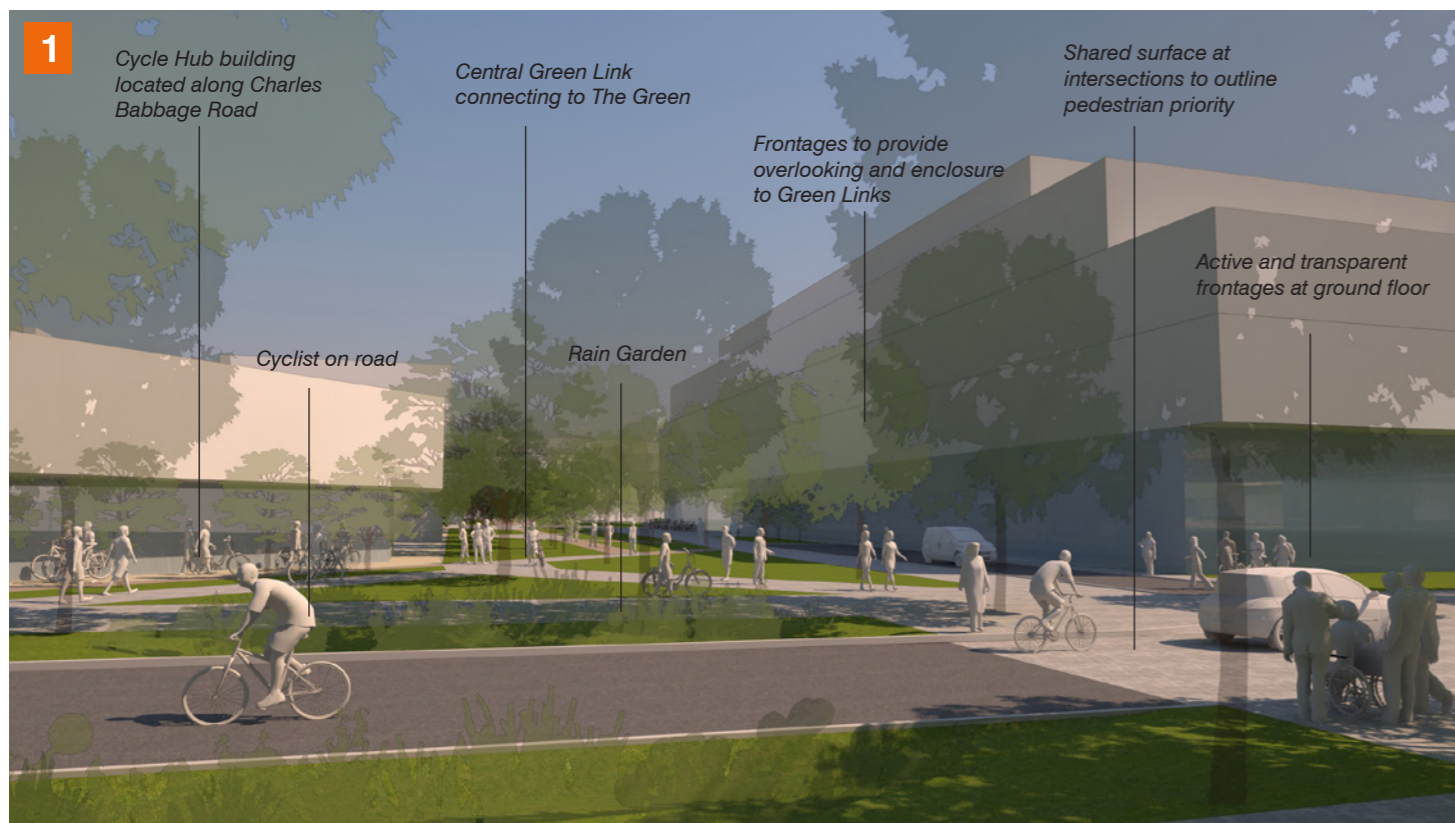

301. Secondary Green Links - view from Charles Babbage looking north towards The Green

View shows how development and landscape elements could frame key links and guide pedestrians towards The Green open space to the north. Links provide additional greenery along Charles Babbage Road.

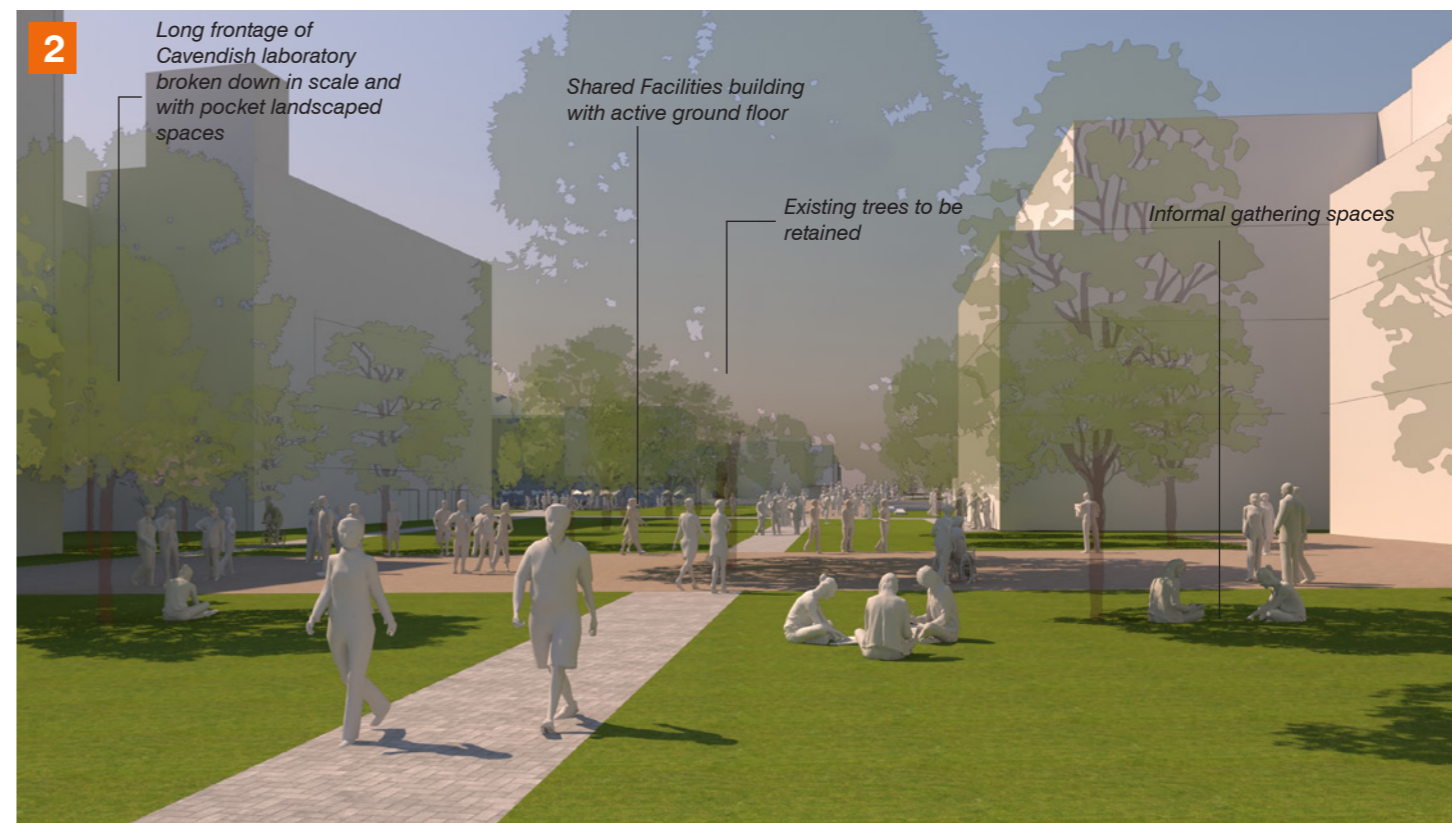

302. Central Green Link - view looking south across The Green towards Charles Babbage Road



Key plan for views

8.2.23 The intent of the Green Links is to create cycle and pedestrian friendly walkways which connect between the key open spaces (The Green, the Forums and the Southern Ecological Corridor).

Character

8.2.24 The Green Links will have a distinct character from other connecting routes, highlighted by parkland trees that relate to trees in some of the Central Gardens, pocket gardens and under storey planting and flower beds.

Materials

8.2.25 Existing trees in Green Links will be maintained and additional ones will be planted to enhance the linearity of these links. A comprehensive palette for the street furniture, light and paving elements is defined to deliver unity along these links and respond to the site wide context.

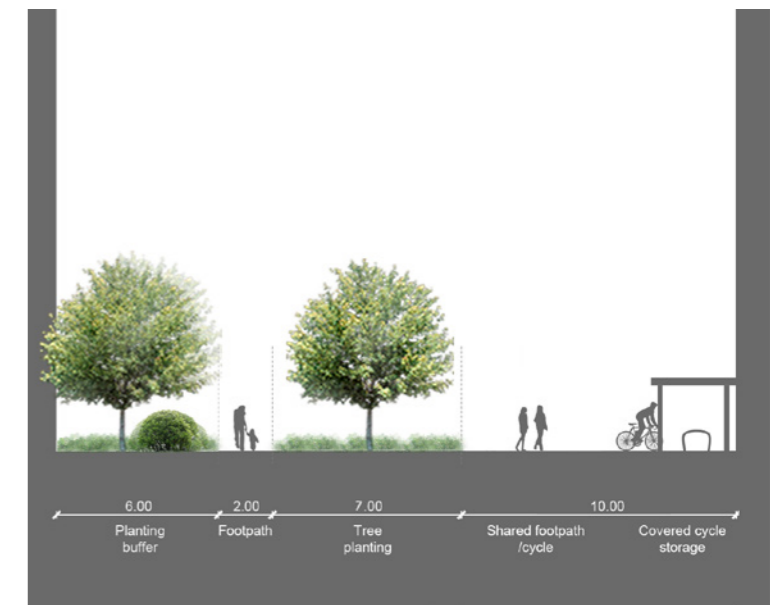

Key plan



303. Central Green Link section A

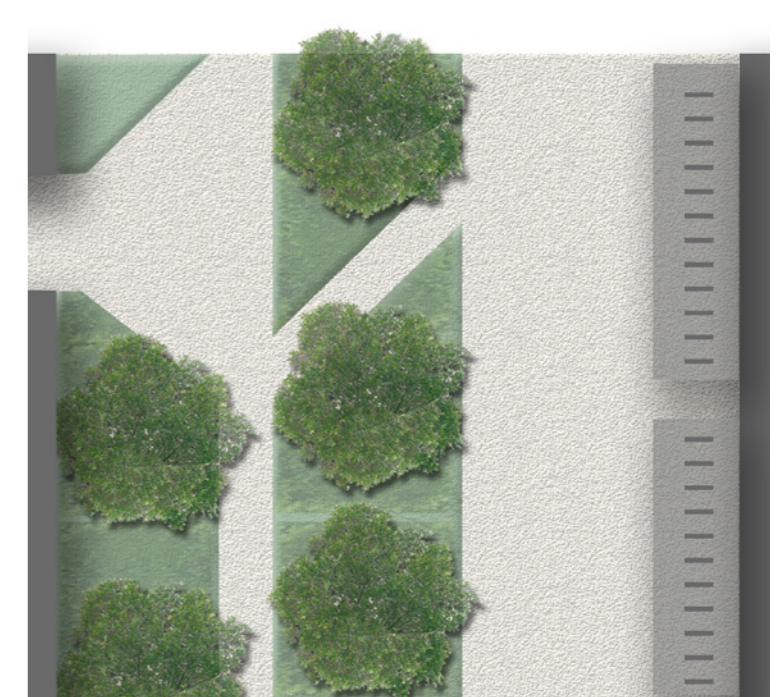

304. Secondary Green Link section B



UNIVERSITY OF
CAMBRIDGE

AECOM